

## Planned development – Playbox Theatre Phase 2 Access Road

The detailed site plan below (as submitted for Planning Approval) details the new Cadet Centre development as submitted and approved under WDC Planning Application W/15/0808. The access road (shown as blue dots below) leads off the new parking area to the right hand side of the Stratford Road entrance and around the south edge of the Dream Factory building, and around to and including the new rear car park layout and delivery bays (scenery etc).

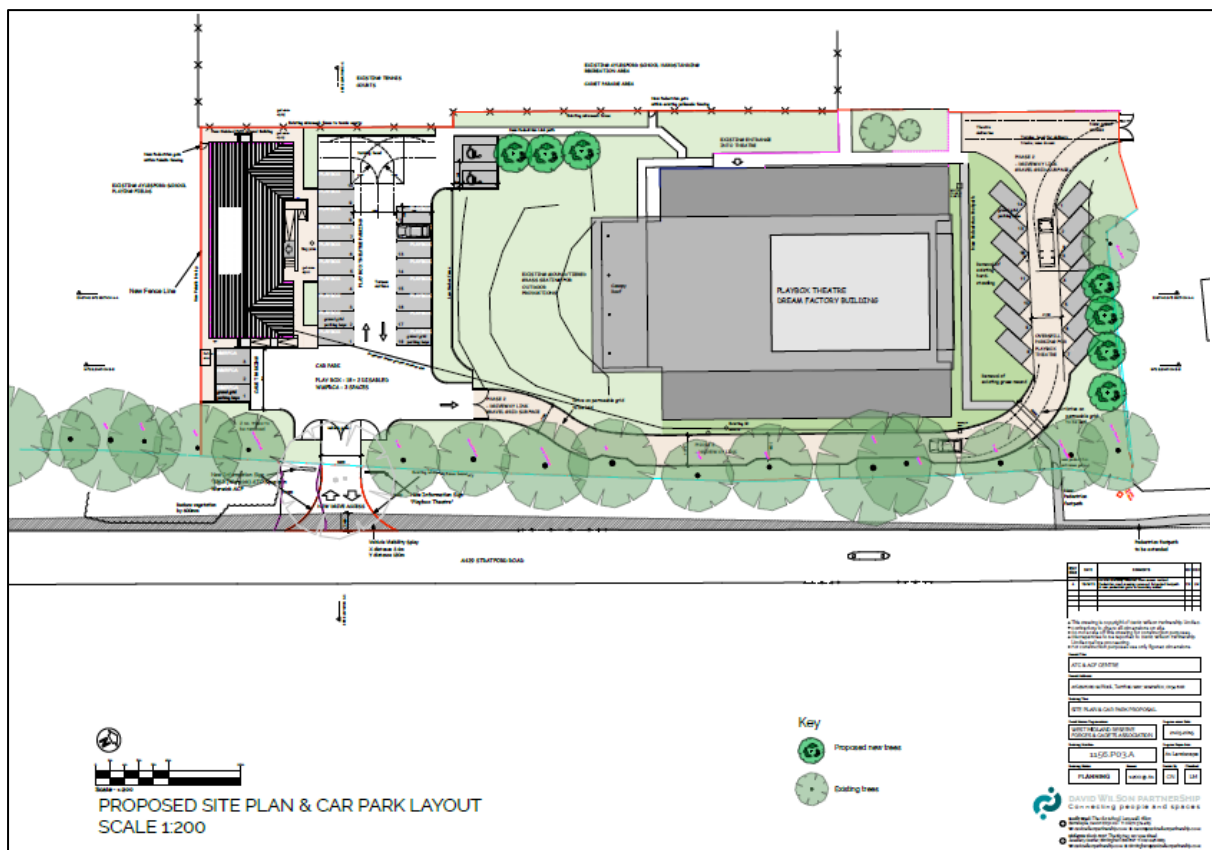

The images below indicate the area of the access road and rear car park layout:

