

**Emma Dudgeon**

---

**From:** halil guner <[REDACTED]>  
**Sent:** 24 March 2014 14:32  
**To:** Emma Dudgeon  
**Subject:** RE: Castle Kebabs

Dear Ms Dudgeon,

Yes, I accept all conditions.

Kind regards,  
Mr Halil Guner

---

**From:** [Emma.Dudgeon@warwickdc.gov.uk](mailto:Emma.Dudgeon@warwickdc.gov.uk)  
**To:** [REDACTED]  
**Subject:** Castle Kebabs  
**Date:** Mon, 24 Mar 2014 14:05:20 +0000

Dear Mr Guner,

Please can you confirm that you accept all conditions asked for by Warwickshire Police. These are as follows:

1. No music to be played in the premises whilst open
2. No child under 16 years to be allowed in to the shop after 11pm, except in the company of an adult
3. Groups congregating outside to be dispersed.
4. CCTV must be installed to the current British Standard, record at all times when licensable activities take place, and must include:  
Cameras must cover entrance and service till  
Head and facial recognition  
Capable of recording and storing 31 days continuously.  
Someone must be on duty when licensable activities take place who is capable of downloading images upon request by an authorised officer.  
The image quality must be of a minimum of 12 frames per second  
The system must be signed off by a Warwickshire Police Architectural Liaison Officer.

Kind regards

**Emma Dudgeon**  
Licensing Enforcement Officer

Health & Community Protection | Warwick District Council | Riverside House | Milverton Hill | Royal Leamington Spa | CV32 5HZ | 01926 456113 | 07702518003

[emma.dudgeon@warwickdc.gov.uk](mailto:emma.dudgeon@warwickdc.gov.uk) | [www.warwickdc.gov.uk](http://www.warwickdc.gov.uk)



**WARWICK DISTRICT COUNCIL**  
Licensing Act 2003

**REPRESENTATION FORM FROM  
RESPONSIBLE AUTHORITIES**

Responsible Authority – Environmental Health, Riverside House, Milverton Hill, L/Spa, CV32 5HZ.

Your Name	Matthew Shirley
Job Title	Technical Officer
Postal and email address	Environmental Sustainability, Warwick District Council, Riverside House, Milverton Hill, Royal Leamington Spa, Warwickshire, CV32 5HZ
Contact telephone number	01926 456730

Name of the premises you are making a representation about	Castle Kebabs
Address of the premises you are making a representation about	46b Saltisford, Warwick, Warwickshire, CV34 4TD

<i>Which of the four licensing Objectives does your representation relate to?</i>	<i>Yes Or No</i>	<i>Please detail the evidence supporting your representation. Or the reason for your representation. Please use separate sheets if necessary</i>
To prevent crime and disorder	No	
Public safety	No	
To prevent public nuisance	Yes	See notes on separate page
To protect children from harm	No	

Suggested conditions that could be added to the licence to remedy your representation or other suggestions you would like the Licensing Sub Committee to take into account. Please use separate sheets where necessary and refer to checklist.	No recommended conditions
------------------------------------------------------------------------------------------------------------------------------------------------------------------------------------------------------------------------------------------------	---------------------------

Comments / Objections / Observations	Environmental Health object to this application
--------------------------------------	-------------------------------------------------

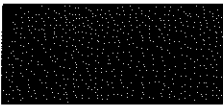
Signed: 

Date: Monday 10<sup>th</sup> March 2014

**Proximity to surrounding residential properties**

The premises are located within a mixed commercial and residential area. There are a large number of residential properties at the rear of the premises on Victoria Mews as well as several properties directly opposite on Parkes Street. The premises are also adjoined by a six bedroom house in multiple occupation which adjoins at the side and from above.

**Previous complaints**

Environmental Health has previously received complaints of noise arising from the premises. These complaints involved disturbances from shouting, slamming doors, revving car engines and moving bins onto the street. These disturbances were occurring late in the evening after closing hours, and as such, we believe that an extension of closing times will reintroduce these disturbances and prolong surrounding residents' exposure to such noise.

The proposals to extend closing hours to 02:00 on Friday and Saturday nights is likely to result in staff remaining at the premises after these hours in order to clean and lock up. In addition to this, the proposals will also result in the kitchen extraction unit being operated into the early hours of the morning, increasing the disturbance to nearby residents.

**Patrons in the street**

The application to extend operating hours until 02:00 will also lead to an increased number of patrons on the street visiting the premises at more unsociable hours. The extension of hours is likely to attract customers out from the town centre and surrounding areas and will cause them to remain in the immediate vicinity of the premises. This will inevitably give rise to public nuisance and further disturbance to local residents as a result of increased noise on the street.

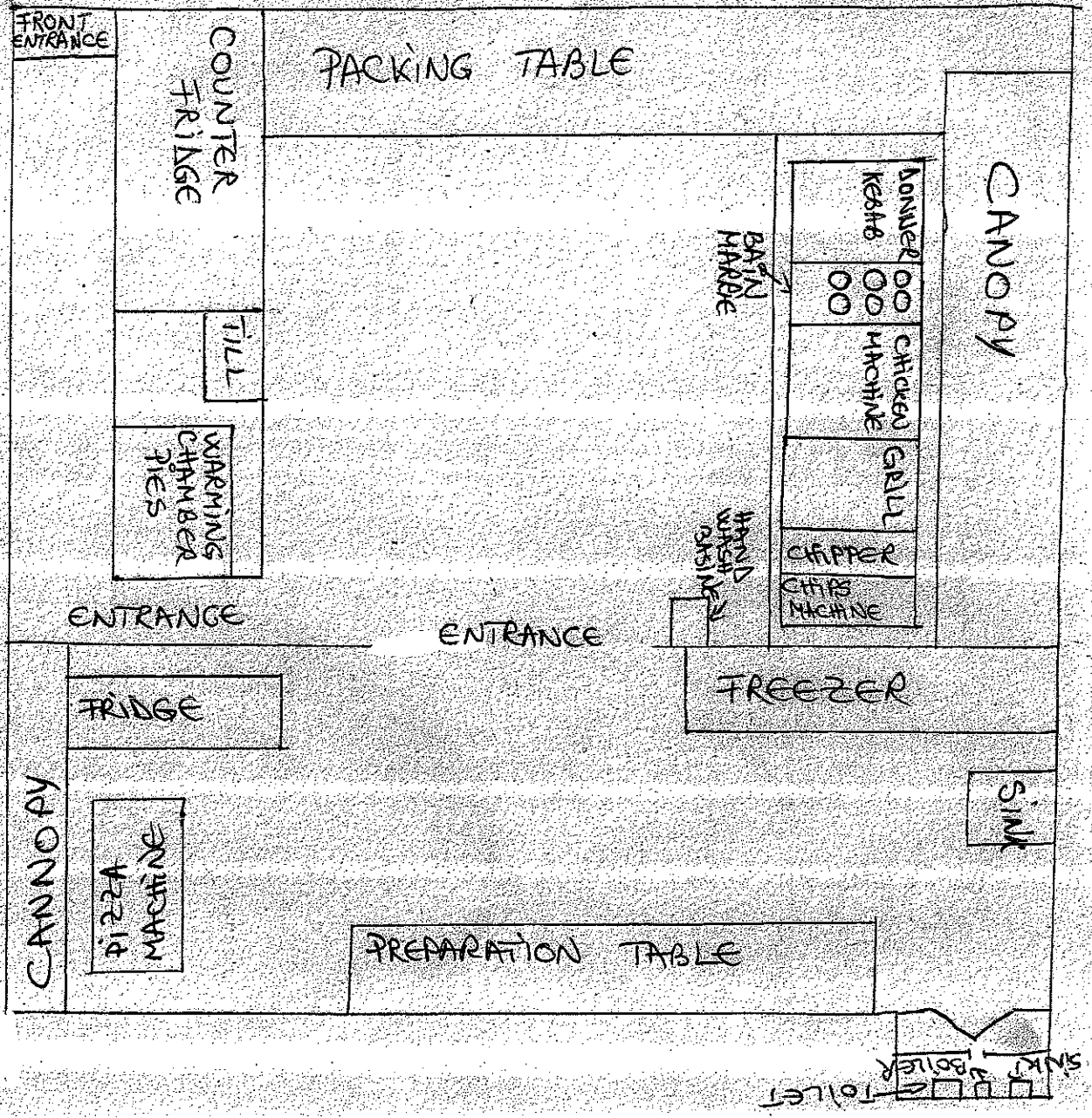

SHOP PLAN

