

Victoria Park & National Bowls Championship Survey

Final Summary Report



Prepared by: The Research Solution

Christine King, Director

Tel: 01905 721440

On behalf of Warwick District Council

Victoria Park & Bowls Championship Final Report – November 2014

CONTENTS	Page
1.0 Introduction, Brief & Methodology	1
1.1 Introduction	1
1.2 Survey Methodology	1
1.3 Survey Days	2
1.4 Reporting	2
1.5 Statistical Reliability	2
1.6 Notes to the Reader	3
2.0 PARK USERS	4
2.1 Summary of Results	4
2.2 Age Groups	4
2.3 Gender	4
2.4 Mode of Transport	5
2.5 Origin of Visitor	5
2.6 Party Composition	6
2.7 Frequency of Visit	7
2.8 Facilities & Park Activities	8
2.9 Rating of Facilities	9
2.10 Awareness of Bowls Championship	11
2.11 Comments	14
3.0 APPENDICES	16

Executive Summary

In April 2014, The Research Solution was commissioned by Warwick District Council to conduct a survey of visitors using Victoria Park, prior to the National Bowls Championship held at the Park in August, during the actual tournament and post the event taking place. Warwick District Council commissioned this survey in order to gain a better understanding of the use of Victoria Park during both the Women's National Championships and for the first time, the Men's National Championship in 2014. A previous survey had been carried out in 2013 and the information from this survey was used in helping to plan for this year's events and for future year's events to be held in the Park. General information relating to the park will be passed on to colleagues in the Council to inform future improvements to the park, as well as general users of the Park itself.

The surveys took place during late June/early July, during the Championships in August and a further wave in late September. A random selection of days was chosen by The Research Solution.

The research was undertaken by a team of fully trained experienced interviewers. The interview period covered both weekdays and weekends. A sample of 801 interviews were completed pre, during and post the event.

- Over two thirds of park users (64%) were aged 44 and under. There was little difference in the age groups of those using the park during the three interview periods.
- Generally the split between male and females was fairly consistent – at roughly two-thirds female - throughout the three waves of interviewing. The number of females using the park during the Bowls Championships was slightly higher than at other periods.
- The majority of park users had travelled to the park in their car (61%).
- The majority of park users came from within Warwickshire (82%) with the West Midlands supplying 9% of park visitors.
- Almost nine out of ten park users were visiting with friends or family with 11% visiting the park on their own.
- Almost half made a trip to the park once a week or more, a fairly high proportion. Lower levels of visitors were at the park once a fortnight (14%) and once a month (11%). A small number of respondents only visited once or twice a year (7%) and 8% were on a first visit to Victoria Park.

- The children's play area/paddling pool was the most regularly used facility with 55% using this area on their visit, followed by the grassed area (50%) and the cycle/running/half mile circuit (45%). Only 14% of park users regularly or occasionally used the tennis courts
- All the ratings for the facilities in the park received high scores. The open grassed areas and the children's play area received the highest scores with a mean average of 4.75 and 4.65 respectively.
- The lowest scores were for the signage with an average mean score of 3.81 and the refreshments/café in the park (3.99) with less than quarter (23%) rating this as "very good".
- The majority of park users were aware that the National Bowls Championships were taking place in Victoria Park during August.
- Overall, almost three quarters (74%) of respondents felt that the impact of the Championships had little or no impact on their park usage. A higher number of pre-event respondents felt they would be deterred from visiting the park whilst the Championships were taking place (13%), falling to only 1% during the event itself.

1.0 INTRODUCTION, BRIEF AND METHODOLOGY

1.1 Introduction

In April 2014, The Research Solution was commissioned by Warwick District Council to conduct a survey of visitors using Victoria Park, prior to the National Bowls Championship held at the Park in August, during the actual tournament and post the event taking place. Warwick District Council commissioned this survey in order to gain a better understanding of the use of Victoria Park during both the Women's National Championships and for the first time, the Men's National Championship in 2014. A previous survey had been carried out in 2013 and the information from this survey was used in helping to plan for this year's events and for future year's events to be held in the Park. General information relating to the park will be passed on to colleagues in the Council to inform future improvements to the park, as well as general users of the Park itself. The surveys took place during late June/early July, during the Championships in August and a further wave in late September. A random selection of days was chosen by The Research Solution.

1.2 Survey Methodology

The research was undertaken by a team of fully trained experienced interviewers. The interview period covered both weekdays and weekends. A sample of 801 interviews were completed pre, during and post the event.

A self-completion survey of the competitors, spectators and officials of the Bowls Championship was undertaken and the results from this survey will be shown in a separate report.

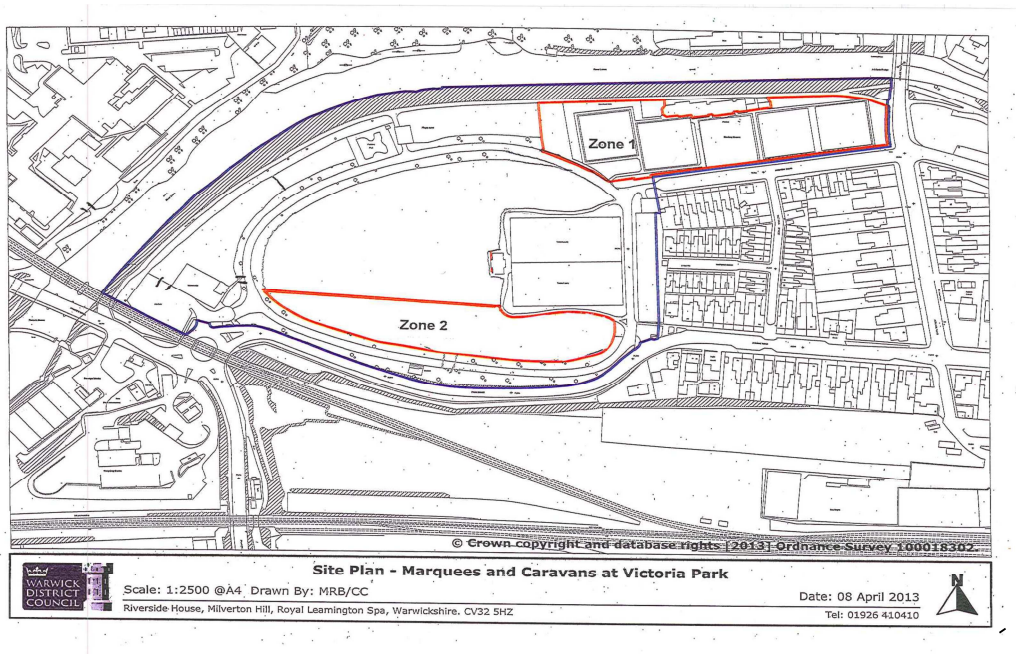

1.3 Survey Days

During the thirty two days of interviewing, 801 interviews were completed. Of the total sample, 25% over eight days was undertaken from mid-June – early July. During the Bowls Championships, 401 interviews were conducted over sixteen days with interviewing beginning on Saturday 2nd August and finishing on Saturday 30th August. Between these dates, a mixture of both weekday and weekends were covered, with interviews conducted between the hours of 10am – 5.30pm. The final wave of interviewing took place at the end of September covering a two week period.

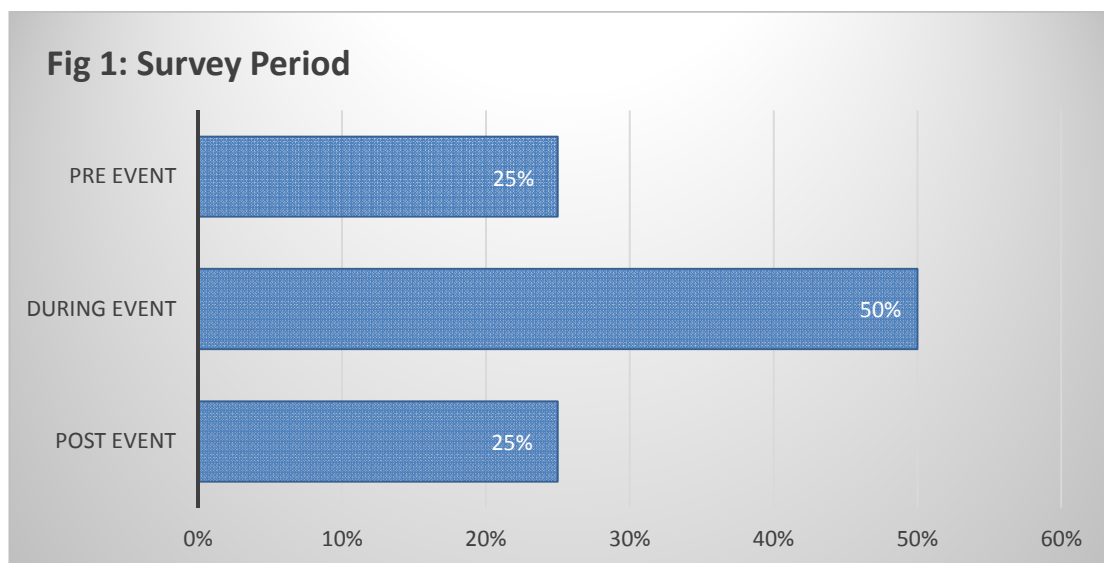

1.4 Reporting

The following report covers the three periods of interviewing that took place in Victoria Park.

1.5 Statistical Reliability

All sample surveys are subject to statistical error that varies with the sample size and the order of magnitude of the research findings being considered. This survey obtained a sample of 801 and the margins within which one can be 95% certain that the true figures in this report will lie are presented below.

Table 1: Statistical Error	
Findings from survey	95% confidence interval
50%	+/- 6.9%
40/60%	+/- 6.8%
30/70%	+/- 6.4%
20/80%	+/- 5.5%
10/90%	+/- 4.2%

This means, for example, we can be 95% certain that if 20% of the sample is found to have a particular characteristic or view, there is an estimated 95% chance that the true population percentage lies in the range of +/- 5.5%, i.e. between 14.5% and 25.5%.

1.6 Notes to the reader

- All percentages are rounded to the nearest whole figure so on occasions figures may not exactly equal 100%
- A "0" indicates a value of less than 0.5%
- A dash (-) indicates no value

2.0 PARK USERS

2.1 Summary of Results

2.2 Age Groups

Over two thirds of park users (64%) were aged 44 and under. There was little difference in the age groups of those using the park during the three interview periods.

	Total	Pre-Event	During Event	Post-Event
17-24	8%	7%	8%	11%
25-34	22%	23%	23%	19%
35-44	34%	35%	35%	30%
45-54	12%	12%	10%	17%
55-64	12%	12%	13%	11%
65-74	10%	9%	10%	11%
75+	2%	2%	2%	2%

2.3 Gender

Of the total number of respondents interviewed, more females were interviewed than males.

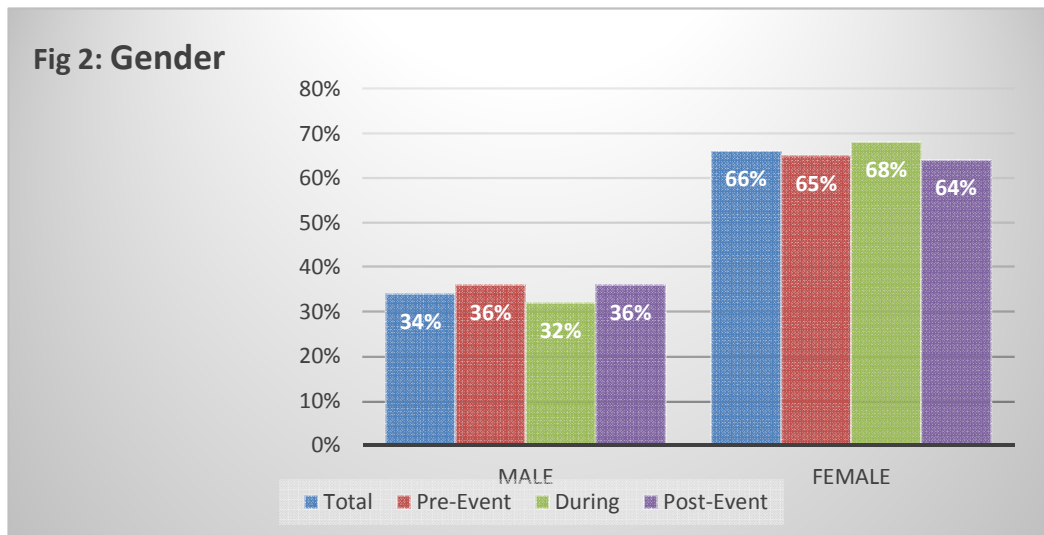

Generally the split between male and females was fairly consistent – at roughly two-thirds female - throughout the three waves of interviewing. The number of females using the park during the Bowls Championships was slightly higher than at other periods.

2.4 Mode of Transport

The majority of park users had travelled to the park in their car (61%).

Table 3: Mode of Transport				
	Total	Pre-Event	During Event	Post-Event
Car	61%	55%	64%	63%
Walked	31%	38%	29%	30%
Other	4%	6%	3%	5%
Bike	3%	2%	5%	2%

There was less use of the car during and after the event than those who visited the park prior to the event, when almost two fifths (38%) had walked to the park. There was little difference across all three periods by cycle users ranging from 2%-5%.

2.5 Origin of Visitor

The majority of park users came from within Warwickshire (82%) with the West Midlands supplying 9% of park visitors. 56% of park users were from Leamington Spa itself, 26% from other places within Warwickshire and 18% came from outside of the County. Visitors from 17 other places across the country had visited the park during the interview period. A full list is shown in Appendix 1.

Table 4: Origin of Visitor				
	Total	Pre-Event	During Event	Post-Event
Warwickshire	82%	85%	79%	86%
West Midlands	9%	10%	9%	10%
Oxfordshire	1%	1%	2%	2%
Northamptonshire	1%	1%	2%	-
Buckinghamshire	1%	1%	1%	1%
Worcestershire	1%	1%	1%	1%

During the Bowls Championships, there were people from within Warwickshire visiting the park when compared to before and after the Championships had taken place.

2.6 Party Composition

801 groups of people were interviewed before, during and after the National Bowls Championship totalling 2,371 individuals. The average number of people per party was 3.0

Almost nine out of ten park users were visiting with friends or family with 11% visiting the park on their own.

Table 5: Visiting Park Alone				
	Total	Pre-Event	During Event	Post-Event
No	89%	88%	92%	82%
Yes	11%	13%	8%	18%

Of the total number of respondents (801), 64% comprised of adults with children, 21% were adults on their own or in a group, 11% were adults out walking their dogs and a small amount (4%) included adults with children and dogs in their party.

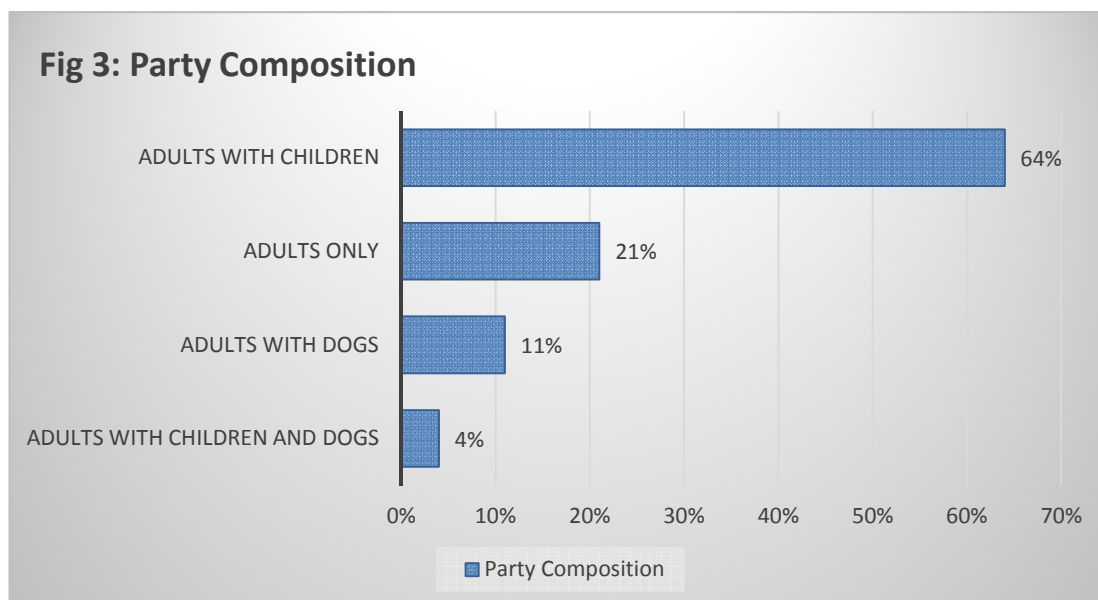

Table 6: Party Composition				
	Total	Pre-Event	During Event	Post-Event
Adults with children	64%	62%	73%	50%
Adults only	21%	24%	15%	29%
Adults with dogs	11%	10%	8%	18%
Adults with children and dogs	4%	5%	4%	4%

As the Championships took place during the main school summer holidays, it is not surprising that there were higher levels of adults with children using the park during this period. Adults out walking their dogs on their own were more prevalent after the Bowls Championships took place than before or after the Championships.

2.7 Frequency of visit

Park users were asked how often they visited during the summer months. Almost half made a trip to the park once a week or more, a fairly high proportion. Lower levels of visitors were at the park once a fortnight (14%) and once a month (11%). A small number of respondents only visited once or twice a year (7%) and 8% were on a first visit to Victoria Park

During the period of the championships, there were fewer frequent visitors making a trip to the park. Just over two fifths (44%) visited once a week or more compared with over half before and after the Championships took place. School holidays, weather and the event itself could all affect the frequency of visits to the park.

Table 7: Frequency of Visit

	Total	Pre-Event	During Event	Post-Event
Once a week or more	49%	53%	44%	56%
About once a fortnight	14%	15%	14%	14%
About once a month	11%	13%	10%	11%
A few times a year	11%	10%	11%	11%
Once or twice a year	7%	3%	11%	3%
First visit	8%	8%	9%	6%

Over two thirds (69%) of all park users visited during the winter months. Those interviewed during the Bowls Championship (August) were less likely to visit the park in winter months than those interviewed in June, before the Championships took place.

Table 8: Visit during winter months

	Total	Pre-Event	During Event	Post-Event
Yes	69%	70%	63%	80%
No	31%	30%	37%	20%

2.8 Facilities & Activities undertaken in park

The children's play area/paddling pool was the most regularly used facility with 55% using this area on their visit, followed by the grassed area (50%) and the cycle/running/half mile circuit (45%). Only 14% of park users regularly or occasionally used the tennis courts

Table 9: Facilities & activities undertaken in park

	<i>Regularly</i>	<i>Occasionally</i>	<i>Never</i>
Children's play areas/paddling pool	55%	18%	27%
Cycling/running/half mile circuit	45%	19%	36%
Grassed areas	50%	30%	20%
Tennis courts	4%	10%	86%

Table 10: Facilities & activities undertaken in park

Children's play areas/paddling pool	<i>Pre-Event</i>	<i>During Event</i>	<i>Post-Event</i>
Regularly	54%	59%	49%
Occasionally	14%	22%	15%
Never	32%	19%	36%
Cycling/running/half mile circuit			
Regularly	41%	39%	60%
Occasionally	14%	21%	21%
Never	45%	40%	19%
Grassed areas			
Regularly	59%	47%	48%
Occasionally	20%	35%	30%
Never	21%	18%	23%
Tennis Courts			
Regularly	5%	4%	4%
Occasionally	10%	11%	7%
Never	85%	85%	89%

Regular use of the paddling pool before and during the Bowls Championship was higher than after the event took place. This is not surprising due to the time of year the interviews took place (late September).

Generally there was more use of the cycling/running/half mile circuit track after the Championships took place than before or during (60% compared with 41% and 39% respectively).

Occasional use of the grassed areas within the park were highest during the Bowls Championships held in August (35%) falling to 20% before the Championships.

There was little difference in the use of the tennis courts before, during or after the Championships took place with only small numbers of people making use of the tennis courts (4%-5%).

2.9 Rating of facilities in park

All the ratings for the facilities in the park received high scores. The open grassed areas and the children's play area received the highest scores with a mean average of 4.75 and 4.65 respectively.

Table 11: Ratings				
	<i>Open Grassed Areas</i>			
	Total	Pre-Event	During	Post-Event
Mean Score	4.75	4.74	4.71	4.82
Very Good	75%	77%	72%	82%
Fairly Good	24%	21%	28%	19%
Fairly Poor	1%	2%	0%	-
Very Poor	0%	1%	-	-
	<i>Tennis Courts</i>			
Mean Score	4.55	4.55	4.55	4.56
Very Good	56%	55%	57%	56%
Fairly Good	43%	45%	41%	44%
Fairly Poor	1%	-	2%	-
Very Poor	-	-	-	-
	<i>Paddling Pool</i>			
Mean Score	4.43	4.40	4.50	4.28
Very Good	51%	52%	54%	44%
Fairly Good	42%	38%	42%	45%
Fairly Poor	5%	6%	4%	8%
Very Poor	2%	3%	-	4%
	<i>Children's Play Area</i>			
Mean Score	4.65	4.61	4.68	4.62
Very Good	67%	63%	69%	65%

Fairly Good	31%	34%	29%	32%
Fairly Poor	2%	2%	2%	3%
Very Poor	-	-	-	-
Cycling/Running Circuit				
Mean Score	4.61	4.60	4.59	4.66
Very Good	62%	60%	60%	66%
Fairly Good	38%	39%	40%	34%
Fairly Poor	0%	1%	0%	-
Very Poor	-	-	-	-
Car Parking				
Mean Score	4.22	4.32	4.12	4.33
Very Good	39%	44%	34%	43%
Fairly Good	47%	45%	47%	48%
Fairly Poor	12%	9%	16%	9%
Very Poor	2%	2%	3%	1%
Refreshments/Café				
Mean Score	3.99	4.04	4.10	3.67
Very Good	23%	32%	22%	15%
Fairly Good	58%	45%	67%	49%
Fairly Poor	15%	19%	10%	22%
Very Poor	4%	4%	1%	13%
Signage				
Mean Score	3.81	3.84	3.81	3.78
Very Good	14%	21%	14%	6%
Fairly Good	60%	52%	58%	73%
Fairly Poor	19%	18%	22%	15%
Very Poor	7%	9%	6%	7%

The lowest scores were for the signage with an average mean score of 3.81 and the refreshments/café in the park (3.99) with less than quarter (23%) rating this as "very good".

Car parking was less of an issue pre and after the Bowls Championships took place than during the event itself.

Those respondents who rated the facilities fairly poor or poor were asked to explain why. Signposting/incorrect signage was an issue for a third of all respondents (34%). This was more prevalent during the Bowls Championship with increased numbers of people in the park. Not enough parking/difficult to park was cited by a quarter of park users, again with the lowest scores given during the Championships (only 22% rating it very good).

The paddling pool was also a concern as it was dirty and had broken glass in and around the edges and was in need of improvement (18%). The café situated within Victoria Park was not open enough, with inconsistent and erratic opening hours (14%) and had a poor/limited menu on offer (9%) along with too expensive (5%). Other comments included: More/better toilets,

better facilities for younger children, more facilities in general needed and not much at the park (3% respectively). A full list is shown in Appendix 2.

2.10 Awareness of National Bowls Championship taking place

The majority of park users were aware that the National Bowls Championships were taking place in Victoria Park during August. Awareness was greater during and after the Championships (82% and 85% respectively). Almost half of park users interviewed before the National Championships took place were not aware that the event was to be held in the park during August.

Table 12: Awareness of National Bowls Championship				
	Total	Pre-Event	During Event	Post-Event
Yes	75%	54%	82%	85%
No	25%	47%	18%	15%

2.11 Impact of National Bowls Championship on use of park

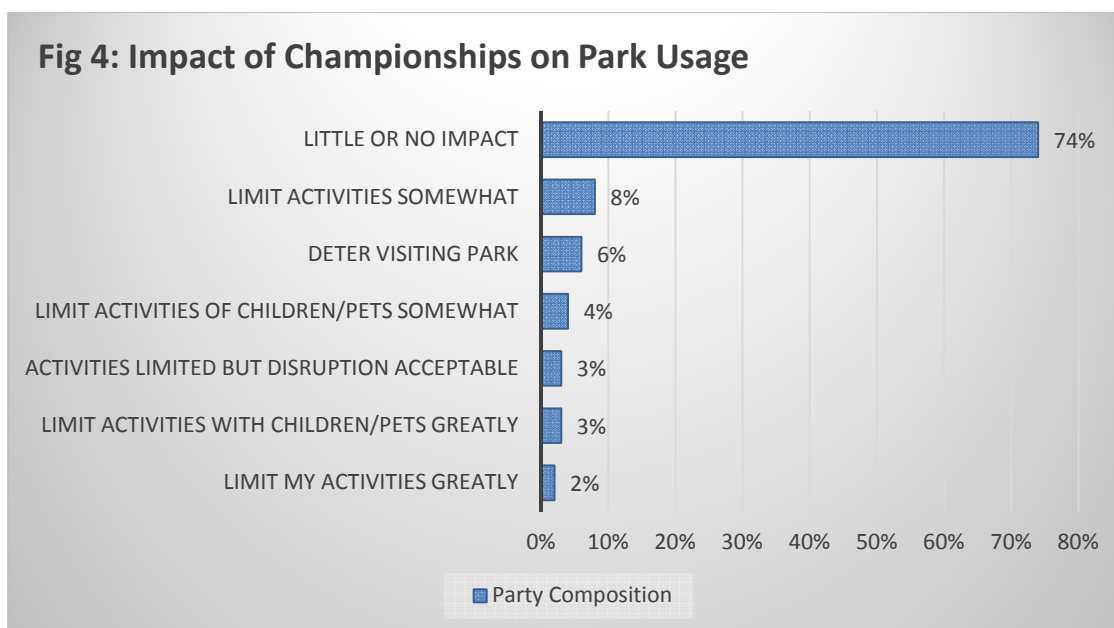

Overall, almost three quarters (74%) of respondents felt that the impact of the Championships had little or no impact on their park usage.

Respondents felt that there was less impact during the Championships (79%) than before the event took place (64%). A higher number of pre-event respondents felt they would be deterred from visiting the park whilst the Championships were taking place (13%), falling to only 1% during the event itself. Around 8% of pre-event visitors felt that the Bowls Championships would limit greatly theirs and the children/pets activities whilst the Championships were taking place.

Table 13: Impact of National Bowls Championship

	Total	Pre-Event	During Event	Post-Event
Little or no impact	74%	64%	79%	75%
Limit my activities somewhat	8%	9%	9%	6%
Will deter me from visiting again during the Nationals	6%	13%	1%	8%
Limit the activities of my children/ & or pets somewhat	4%	4%	5%	4%
Activities are disrupted but the disruption is acceptable	3%	2%	4%	2%
Limit the activities of my children/ & or pets greatly	3%	4%	2%	5%
Limit my activities greatly	2%	4%	1%	1%

Across all three interviewing periods, the majority of respondents did not feel that the National Bowls Championship would affect them or their children/pets very much from using the park.

Respondents were also asked to provide additional comments on what impact the Championships and the parking had on their use of the park. Specific comments were given in response to the question but respondents also commented on other general aspects of the park which were recorded and included in the table below. The comments have been grouped from the original list of comments provided. A selection of both positive and negative responses are shown overleaf.

- *Can't see what all the complaints are about, well fenced off and not taking up too much room*
- *This year's so much better than expected / Bowlers using much less space*
- *Phenomenally very good for Leamington Spa.*
- *Encouraged us to use this park as we like to see the bowls. Have come here with the dog more frequently this month*
- *Very well managed and they stop the traffic for you to walk through.*

- *Difficult parking for free. The free car parking should be for people using the park not for the people here for bowls who stay all day and don't pay, not fair on parents wanting to use park for a few hours*
- *Even though well contained this year, as a parent I still worry about children running and cycling as lose visual contact with them*
- *I don't feel comfortable running where the cars parked. 28 days too long during school holidays*
- *Had to park off site, a month a long time to park on grass and for the disruption*
- *The circuit was disrupted for people like me walking the dog.*

Overall, over half (56%) felt that the Bowls Championship did not have any impact on their park usage, around 55% during the actual month when the Championships took place, Interestingly this rose to over two thirds (67%) once the event had finished. During the Championships, 15% of respondents referred to parking related issues, in particular the lack of parking for park users and the use of the free car park by bowlers. This figure was 8% pre-event and 12% after the event. A full list is shown in Table 14.

Table 14: Impact of Championships on park usage				
	Total	Pre-Event	During	Post-Event
No impact/none	56%	48%	55%	67%
No car parking left/difficult to park	13%	8%	15%	12%
Too busy	8%	19%	4%	4%
Not safe for children/not able to run freely	6%	12%	4%	3%
grass roped off	5%	6%	4%	5%
Well organised/much better this year	4%	3%	6%	2%
tracks cordoned off/can't use all track	3%	7%	3%	1%
too many cars	2%	3%	2%	1%
cuts up the grass	2%	3%	1%	1%
I walk rather than drive	2%	1%	3%	1%
Bowlers using free car park and not their own	2%	-	2%	4%
Really good for Leamington Spa	1%	1%	-	1%
Inconvenient	2%	1%	0%	5%
Cannot let dog off lead	1%	3%	1%	1%
Have visited more because of bowls	1%	-	2%	-
Championship too long	1%	-	1%	1%
Dangerous	1%	1%	1%	1%
Parking should not be in the park at all	1%	2%	0%	-
Used bikes instead of car	1%	-	1%	1%
Need disabled parking	0%	-	0%	-
Good that the bowlers have own car park	0%	-	1%	-
More equipment in park needed	0%	1%	-	-
Cannot picnic when the bowls are here	0%	1%	-	-
Brilliant	0%	-	0%	-

2.12 Additional Comments on Park & Car Parking

There were a variety of comments on the park and car parking arrangements during the Championships. Nearly three out of ten (29%) respondents again felt that the parking arrangements during the Championships had little or no impact on their visit to the park. This increased to 34% during the event, falling to 28% after the Championships had finished.

Although this question related specifically to the park and car parking arrangements during the Championships, many additional comments were captured about the park in general. Comments and suggestions from users of the park will hopefully prove useful to Warwick District Council to make improvements to the park and facilities within it, to benefit all those who use the park throughout the year.

Just over a quarter (26%) felt that the town really benefitted from the Championships and that they were good for the town/local economy and brought many visitors to Leamington Spa. Parking was an issue for 10% of all those interviewed, 16% before the Championships took place, falling to 9% during the event, on a par with those respondents who were interviewed three weeks after the Championships had finished.

Respondents thought that the event was really well organised this year and the improvements to the parking had had less impact on their use of the park during August 2014. Respondents felt that the Bowls Championship was great to watch and created a really great atmosphere in the park. Comments about the bowlers using the free car park meant for park users was an issue for some respondents but generally most felt that this had improved since last year. A full list of comments is shown in Appendix 3.

Table 15: Additional comments on park and car parking during Championship				
	Total	Pre-Event	During	Post-Event
No Impact	29%	15%	34%	28%
Bowls good for the town/local economy	26%	17%	24%	35%
Parking could be better/more parking needed/larger car park/use own car park	10%	16%	9%	8%
Well organised this year/much better	8%	1%	12%	5%
Like watching the bowls/good to see it being used	7%	4%	7%	10%
Beautiful/lovely/Good Park	6%	10%	5%	7%
All good/fine/great atmosphere in park	6%	5%	5%	9%
More toilets needed/need to be cleaned/updated	3%	3%	2%	4%
More for younger children	3%	5%	3%	2%
Dog mess not being cleaned up/dogs should be on lead	2%	5%	1%	2%
Park and Ride	2%	4%	1%	2%

Free car park is good	2%	2%	3%	2%
No parking on grass	2%	1%	3%	3%
Cafe needs to be open longer	1%	2%	0%	1%
More signage for cafe/toilets	1%	1%	1%	-
More benches needed/picnic tables	1%	1%	1%	-
Park is Clean/Tidy	1%	1%	1%	1%
Need exercise/fitness equipment	1%	2%	0%	-
Green area/lots of space still to play	1%	3%	1%	-
Good for children	1%	3%	0%	-
More security patrols	1%	2%		1%
Cars too close to children	1%	1%	-	2%
Paddling pool closed	1%	3%	-	-
Bowls should be at end of school holidays/disruption for local people/area/too much space used	1%	1%	1%	1%
More for older children	1%	-	2%	2%
Needs a football pitch	1%	-	1%	1%

3.0 APPENDICES

Appendix 1: Origin of Visitors

	TOTAL	Pre Event	During	Post-Event
	801	200	401	200
Warwickshire	82%	85%	79%	86%
West Midlands	9%	10%	9%	10%
Oxfordshire	1%	1%	2%	2%
Northamptonshire	1%	1%	2%	-
Buckinghamshire	1%	1%	1%	1%
Worcestershire	1%	1%	1%	1%
Leicestershire	0%	1%	1%	-
Nottinghamshire	0%	-	1%	1%
Cambridgeshire	0%	-	1%	-
Yorkshire south	0%	-	0%	1%
Hertfordshire	0%	-	1%	-
Gloucestershire	0%	-	0%	-
Kent	0%	-	0%	1%
Berkshire	0%	-	0%	-
Devon	0%	1%	0%	-
Somerset	0%	-	0%	-
Italy	0%	1%	-	-
Essex	0%	1%	-	-
Norfolk	0%	-	0%	-
Wiltshire	0%	-	-	1%
Scotland	0%	-	0%	-
South Wales	0%	-	0%	-
West Wales	0%	-	0%	-

Appendix 2: Rating of Facilities – Fairly or Very Poor

	TOTAL	Pre Event	During	Post-Event
	267	67	134	66
Lack of signage/hard to find/update signs	34%	31%	37%	33%
Not enough car parking/overflow parking difficult	24%	21%	26%	21%
Paddling pool unclear/glass in it/needs improving	18%	23%	8%	34%
Cafe not open enough/hard to find	14%	10%	7%	33%
Poor/limited menu	9%	16%	6%	8%
Too expensive and is cash only	5%	9%	4%	3%
More/better toilets	3%	7%	1%	2%
More facilities for younger children	3%	1%	3%	3%
Not enough facilities/none noticed	3%	-	5%	-
Not much here	3%	-	6%	-
Dog mess/lazy owners/need to be on lead	2%	6%	1%	-
Slide needed	2%	3%	1%	2%
More free parking	2%	-	4%	-
Grass needs regularly cutting/too long	1%	4%	1%	-
Whole play area needs revamping	1%	3%	-	3%
Slide is dangerous	1%	-	1%	-
Needs updating	1%	-	1%	-
Cafe staff rude	1%	-	3%	-
Height restrictions in car park	1%	-	2%	-
Park not welcoming, no atmosphere	1%	-	1%	-
Need toilets closer to children's area	1%	-	1%	-
Cyclists go too fast/ignoring no cycling signs	0%	1%	-	-
Ice cream van needed	0%	1%	-	-
Track needs marking for distance	0%	1%	-	-
Display/interpretation panels need to be restored	0%	1%	-	-
More facilities available to rent	0%	-	1%	-
Don't like them parking on grass	0%	-	1%	-
Tennis court poor surface	0%	-	1%	-
Need an ATM near cafe	0%	-	-	2%

Appendix 3: Additional Comments

	TOTAL	Pre Event	During	Post-Event
	747	149	398	200
No Impact	29%	15%	34%	28%
Bowls good for the town	26%	17%	24%	35%
Parking could be better/more parking needed/larger car park	10%	16%	9%	8%
Well organised	8%	1%	12%	5%
Like watching the bowls/good to see it being used	7%	4%	7%	10%
Good Park	6%	10%	5%	7%
All good/fine/good atmosphere	6%	5%	5%	9%
More toilets needed/need to be cleaned/updated	3%	3%	2%	4%
More for younger children	3%	5%	3%	2%
Dog mess not being cleaned up/dogs should be on lead	2%	5%	1%	2%
Park and Ride	2%	4%	1%	2%
Free car park is good	2%	2%	3%	2%
No parking on grass	2%	1%	3%	3%
Cafe needs to be open longer	1%	2%	0%	1%
More signage for cafe/toilets	1%	1%	1%	-
More benches needed/picnic tables	1%	1%	1%	-
Clean/Tidy	1%	1%	1%	1%
Needs exercise equipment	1%	2%	0%	-
Green area/lots of space	1%	3%	1%	-
Good for children	1%	3%	0%	-
More security patrols	1%	2%		1%
Cars too close to children	1%	1%	-	2%
Paddling pool closed	1%	3%	-	-
Bowls should be at end of school holidays/disruption for local people/area/too much space used	1%	1%	1%	1%
More for older children	1%	-	2%	2%
Needs a football pitch	1%	-	1%	1%
Good amount of bins provided	0%	1%	-	-
Pool is unclean/health concern	0%	1%	-	1%
Good meeting place	0%	1%	-	-
Park should be used for more events like Bowls	0%	1%	-	1%
Ice cream van needed	0%	1%	-	-
Like the paddling pool	0%	1%	0%	-

Too much litter	0%	1%	-	-
Rats/wildlife in sandpit/pool	0%	1%	-	-
Should be free tennis courts	0%	1%	-	-
cyclists on footpaths	0%	1%	-	1%
Car park better defined	0%	1%	0%	-
Needs a tuck shop	0%	-	1%	-
Bring back cricket here	0%	1%	0%	-
Cycle racks needed	0%	-	1%	-
More information on event	0%	-	1%	1%
Bring the Steam Engine back	0%	-	1%	-
Rowdy youths in park	0%	-	0%	-
Make it more accessible to people	0%	-	0%	-
Very well organised	0%	-	0%	-
River bank needs to be fenced off	0%	-	1%	-
Resurface Tennis courts	0%	-	0%	-
Paths need cleaning	0%	-	0%	-
Good for families	0%	-	0%	-
Good eating facilities close nearby park	0%	-	0%	-
More water features in pool	0%	-	0%	-
Bring skate park back/bmx track wanted	0%	-	0%	1%
Feels safer having more people in park	0%	-	0%	-
Cycle track/circuit partly closed	0%	-	1%	-
Better baby changing facilities	0%	-	-	1%
Tried to stop parking before but no use	0%	1%	-	-
More info on Internet	0%	1%	-	-
Keep to bowling area	0%	-	-	1%
Slide needed	0%	-	0%	-
Better maintenance of park	0%	-	-	1%
Tennis courts under cover	0%	-	-	1%
Don't allow caravans	0%	-	-	1%
Liked the flags down the parade	0%	-	-	1%