

Licensing & Regulatory Panel

Wednesday 26 August 2015

A Licensing & Regulatory Panel will be held at the Town Hall, Royal Leamington Spa on Wednesday 26 August 2015 at **10.00 am**.

Membership: Councillors Cain, Miss Grainger and Weed.

Emergency Procedure

At the beginning of the meeting the emergency procedure for the Town Hall will be announced.

Agenda

1. **Appointment of Chair**

To appoint a Chair for the meeting.

2. **Declarations of Interest**

Members to declare the existence and nature of interests in items on the agenda in accordance with the adopted Code of Conduct.

Declarations should be entered on the form to be circulated with the attendance sheet and declared during this item. However, the existence and nature of any interest that subsequently becomes apparent during the course of the meeting must be disclosed immediately. If the interest is not registered, Members must notify the Monitoring Officer of the interest within 28 days.

Members are also reminded of the need to declare predetermination on any matter.

If Members are unsure about whether or not they have an interest, or about its nature, they are strongly advised to seek advice from officers prior to the meeting.

3. **Application for a variation of a premises licence under the Licensing Act 2003 for Orchard Corner Convenience Store, 1-2 The Shopping Centre, St Margaret's Road, Whitnash.**

To consider a report from Health & Community Protection **(Item 3/Page 1)**

Published Thursday 13 August 2015

General Enquiries: Please contact Warwick District Council, Riverside House,
Milverton Hill, Royal Leamington Spa, Warwickshire, CV32 5HZ.

Telephone: 01926 353362

E-Mail: committee@warwickdc.gov.uk

Enquiries about specific reports: Please contact the officers named in the reports.

Details of all the Council's committees, councillors and agenda papers are available via our website www.warwickdc.gov.uk/committees

Please note that the majority of the meetings are held on the first floor at the Town Hall. If you feel that this may restrict you attending this meeting, please call (01926) 353362 prior to this meeting, so that we can assist you and make any necessary arrangements to help you attend the meeting.

The agenda is also available in large print, on request, prior to the meeting by calling 01926 353362.

| | | |
|---|---|--------------------------|
|  Licensing & Regulatory Committee 26 August 2015 | | Agenda Item No. 3 |
| Title | Application for a variation of a premises licence under the Licensing Act 2003 for Orchard Corner Convenience Store, 1-2 The Shopping Centre, St Margaret's Road, Whitnash. | |
| For further information about this report please contact | Emma Dudgeon, Licensing Enforcement Officer, Health and Community Protection. Tel: 01926 456113 Emma.dudgeon@warwickdc.gov.uk | |
| Wards of the District directly affected | None | |
| Is the report private and confidential and not for publication by virtue of a paragraph of schedule 12A of the Local Government Act 1972, following the Local Government (Access to Information) (Variation) Order 2006? | Yes | |
| Date and meeting when issue was last considered and relevant minute number | N/A | |
| Background Papers | None | |

| | |
|--|----|
| Contrary to the policy framework: | No |
| Contrary to the budgetary framework: | No |
| Key Decision? | No |
| Included within the Forward Plan? (If yes include reference number) | No |
| Equality and Sustainability Impact Assessment Undertaken | No |
| | |

| | | |
|--|-------------|--------------------|
| Officer/Councillor Approval | | |
| Officer Approval | Date | Name |
| Chief Executive/Deputy Chief Executive | | |
| Head of Service | | Marianne Rolfe |
| CMT | | |
| Section 151 Officer | | |
| Monitoring Officer | | |
| Finance | | |
| Portfolio Holder(s) | | Moira-Ann Grainger |
| Consultation & Community Engagement | | |
| N/A | | |
| Final Decision? | | Yes |
| Suggested next steps - None | | |

1. SUMMARY

- 1.1 Warwick District Council Licensing Authority has received a valid application for a variation of a premises licence from Mr Lakhmir Singh Garewal.
- 1.2 Representations have been received in relation to this application for the consideration of the panel in the determination of the application.

2. RECOMMENDATION

- 2.1 Members are asked to consider the information contained in this report and decide whether the application for a variation of the premises licence for Orchard Corner Convenience Store should be approved and, if so, whether the licence should be subject to any conditions.

3. THE APPLICATION

- 3.1 Mr Garewal applied for a variation of the premises licence on 6 July 2015. The application is to request the extension of the hours the premises are able to sell alcohol for consumption off the premises only. A table showing the variation to the hours is shown below.

| | Sale of Alcohol for Consumption off the premises | Opening hours |
|-----------------------|--|---|
| Current licence | Every day from 09.30 to 23:00 | Sunday to Thursday from 06:00 to 23:30 Friday and Saturday from 06:00 to 00:00 |
| Variation application | Every day from 07:00 to 23:00 | No change |

- 3.2 An operating schedule which has been submitted by the applicant and will form part of any licence issued has been supplied as follows:

General

Follow licensing laws on very strict leases.

No Id no sale.

Stick to the licensing times (hours).

No sales to customers who already have had too much to drink.

We make sure no one passes the drinks over to underage children.

No sales to the troublemakers.

The prevention of crime and disorder

We have fully operational CCTV system with 14 cameras that covers inside and outside of the premises.

We are a small family business and follow all the licensing rules on very strict leases.

We think the whole area knows now that we follow the rules very strictly.

Public Safety

Health and Safety Risk Assessments must be carried out regularly.

CCTV must be installed and used. It must be compliant with the current British standard and must include:

Cameras must cover all public areas with no blind spots.

Head and facial recognition.

Capable of recording and storing 31 days continuously.

Someone must be on duty when licensable activities take place who is capable of downloading images upon request by an authorised officer.

The image quality must be of a minimum of 12 frames per second.

The system must be signed off by Warwickshire Police Architectural Liaison Officer.

A written record of persons authorised to sell alcohol must be maintained and available for inspection.

A refusal book must be kept and maintained.

Customers usually buy their wine and spirits and take them home.

We keep an eye on outside the premises and make sure no drinking in the forecourt or the car park.

The prevention of public nuisance

A management policy must be in place to monitor the external areas of the premises and the conduct of the customers.

A notice to customers regarding consideration for neighbours must be displayed in a clear and prominent position.

The premises must join and stay a member of the retail watch schemes.

A strict policy must be in force not to serve drunken customers.

Challenge 25 must be in force.

Because we follow the rules on strict and firm leases, all our customers know that we do not stand for any nuisance. We totally refuse to serve who appears to be under the influence of drink or drugs. We always watch out that no one passes any drinks or cigarettes to the children.

The protection of children from harm

Challenge 25 must be implemented and staff must be fully trained in its application.

Alcohol must be kept away from children's confectionary shelves.

Signs must be put on shelves regarding No ID No Sale on alcohol shelves.

Spirits must be kept behind the counter away from children.

We have been in these premises for over four years now. We have never had cause for any concern. All the alcohol, wines, beers and spirits are kept and displayed away from the day to day products.

We are fully alarmed with extensive CCTV system and never sell any of these products to underage and watch out that no one passes drinks to underage children.

- 3.3 Representations have been received from six residents and one business in the vicinity of the premises. Objections from residents are attached as appendices 1 to 6 and the objection from the business is attached as appendix 7. One resident requested that their details be kept private from the public and therefore their details have been redacted.

3.4 There have been no representations received from:

- Warwickshire Police
- Fire Authority
- Enforcement Agency for Health and Safety.
- The Licensing Authority
- Authority Responsible for Planning
- National Health Service/Public Health
- Body responsible for the protection of children from harm
- Authority responsible for Environmental Health

3.5 The premises currently hold a premises licence with Warwick District Council and the licensing department has no record of any complaints being received in relation to the premises.

3.6 A map of the area of the premises is attached as appendix 8 and a plan of the internal area of the premises submitted by the applicant is attached as appendix 9.

4. **POLICY FRAMEWORK**

4.1 When considering the application the panel must give appropriate weight to:-

- a) The representations received.
- b) Statutory guidance issued by the Secretary of State under Section 182 of the Licensing Act 2003.
- c) The Council's Licensing Policy Statement (attached as appendix 10)
- d) The Licensing Objectives, which are:-
 - i) The Prevention of Crime and Disorder.
 - ii) Public Safety.
 - iii) The Prevention of Public Nuisance.
 - iv) The Protection of Children from Harm.

However, it should only consider those licensing objectives which have been referred to in the representations received.

4.2 The Council's Licensing Policy Statement provides that the authority will take an objective view on all applications and will seek to attach appropriate and proportionate conditions to licences where necessary in order to ensure the promotion of the four licensing objectives. Each application will be judged on its own merits.

4.3 Details of the procedure adopted by the Licensing Committee for Panel Hearings have been supplied to the applicant and those making representations. The procedure will be explained more fully by one of the Council's Legal Team at the commencement of the hearing.

5. **BUDGETARY FRAMEWORK**

5.1 There would be costs associated with any appeal against the decision as set out in 6.1 below.

6. RISKS

- 6.1 Any decision made by the Panel may be appealed against at a Magistrates Court within 21 days of the decision. There would be costs associated with responding to an appeal and the Council could be ordered to pay the Appellants costs if it is deemed to have behaved unreasonably.

Warwickshire Direct

- 3 AUG 2015

Leamington

27/07/15

Alcohol Licensing Team
Warwick District Council
Riverside House, Milverton Hill,
Leamington Spa
CV32 5HZ

Dear Sir/Madam

I wish to object to the alcohol licence variation application by Orchard Convenience Stores, 1-2 The Shopping Centre, St Margarets Road, Whitnash, CV31 2NT

I have an interest in this application that is greater than the general public because I live less than one kilometre from the location.

I object to the application on the following grounds:

Objection 1:

Grounds for objection – *Public Safety*

Reasons for objections:

1. More young youths hanging around the vicinity for longer periods of the day if hours are increased
2. Making area more dangerous for local residents also puts off potential customers to area.

Objection 2:

Grounds for objection – *Prevention of Crime & Disorder*

Reasons for objections:

1. On the 23rd August a youth was stabbed near the store
2. House front door near store was smashed due to alcohol and drugs
3. A gun shot fired near store also down to alcohol and drug abuse

Objection 3:

Grounds for objection – *Protection of Children & Elderly from harm*

Reasons for objections:

1. Nursery close by, alot of youths hanging around vicinity asking other residents to purchase alcohol on their behalf.
2. Elderly scared to come to shop during evening, will be put off in the early mornings if licence for selling alcohol early is granted.

My contact details are:

Jaspal Singh
152 Brunswick Street
Leamington Spa
CV31 2ER

Yours sincerely



Licensing Act 2003 Representation Form



Section 1 - Application Details

I object to the following Application:

Applicant's name (if known): Mr Lakhmir Singh Garewal

Premises name and address: Orchard Corner Convenience Stores, 1-2 The Shopping Centre, St Margarets Road, Leamington Spa, Warwickshire, CV31 2NT

| | |
|---------------------------------|---|
| Application for a | Premises Licence..... <input checked="" type="checkbox"/> |
| | Club Premises Certificate..... <input type="checkbox"/> |
| Application to vary an existing | Premises Licence..... <input type="checkbox"/> |
| | Club Premises Certificate..... <input type="checkbox"/> |
| Application Number | WDCPREM00734 |

Section 2 - Objector details

Individual Objectors Details:

If you are objecting as a representative go to the next section

| | |
|---|---|
| Applicant Title | Mr <input type="checkbox"/> Mrs <input checked="" type="checkbox"/> Miss <input type="checkbox"/> Other _____ |
| Surname | Bains |
| First name(s) | Dil |
| Address (incl postcode): | |
| 152, Beunwich Street, Royal Leamington Spa, Warwickshire CV31 2NT | |

Warwickshire Direct
- 3 AUG 2015
Leamington

Please note that a full copy of your objection (including your name and address) is required to be sent to the applicant and will be a public document at any hearing of this matter.

If you do not wish your objection to be made public please complete the box below and give reasons. If you are not prepared to allow your objection to be made public then it may be ruled as unusable or as being less important than a public objection.

☐

Please tick here if you do not wish your objection to be made public and complete the box below

This is because

If you represent residents or businesses please complete the boxes below

| | |
|--|--|
| Organisation name if applicable | |
| Please state nature of representation: | |

Section - Objection Details

My objection is relevant to the following licensing objective:

You can tick more than one box

- ☒ Prevention of crime and disorder.
- ☒ Prevention of public nuisance.
- ☒ Protection of children from harm.
- ☒ Public safety

- ☒ I object to the application being granted at all
- ☐ I object to the application being granted in it's current form (If you choose this option remember to tell us in the next section what changes you would like to see)

Current times are fine not 7am to 11pm

Our objection is based on the following:

You need to complete this box as fully as possible. If you do not then the Committee may not understand why you have objected.

Please attach supporting documents / further pages as necessary - Please number all extra pages

Crime is increasing two incidents happened 17/7/15 Theft at St Mary's news and one on the 23rd July-2015 Youth stealing drinks. Police has record of this.

Signed....

Date.....

Licensing Act 2003 Representation Form



Section 1 - Application Details

I object to the following Application:

Applicant's name (if known): Mr Lakhmir Singh Garewal

Premises name and address: Orchard Corner Convenience Stores, 1-2 The Shopping Centre, St Margarets Road, Leamington Spa, Warwickshire, CV31 2NT

| | |
|---------------------------------|---|
| Application for a | Premises Licence..... <input checked="" type="checkbox"/> |
| | Club Premises Certificate..... <input type="checkbox"/> |
| Application to vary an existing | Premises Licence..... <input type="checkbox"/> |
| | Club Premises Certificate..... <input type="checkbox"/> |
| Application Number | WDCPREM00734 |

Section 2 - Objector details

Individual Objectors Details:

If you are objecting as a representative go to the next section

| | |
|---|---|
| Applicant Title | Mr <input type="checkbox"/> Mrs <input checked="" type="checkbox"/> Miss <input type="checkbox"/> Other _____ |
| Surname | BASTOCK |
| First name(s) | DENISE |
| Address (incl postcode): FLAT 5, 15 REDLAND ROAD LEAMINGTON SPA CV31 2PB | |

Warwickshire Direct

3 AUG 2015

Leamington

Please note that a full copy of your objection (including your name and address) is required to be sent to the applicant and will be a public document at any hearing of this matter.

If you do not wish your objection to be made public please complete the box below and give reasons. If you are not prepared to allow your objection to be made public then it may be ruled as unusable or as being less important than a public objection.

☐

Please tick here if you do not wish your objection to be made public and complete the box below

This is because

If you represent residents or businesses please complete the boxes below

| | |
|--|--|
| Organisation name if applicable | |
| Please state nature of representation: | |

Section - Objection Details

My objection is relevant to the following licensing objective:

You can tick more than one box

***You can tick more than
one box***

- ☒ Prevention of crime and disorder.
- ☐ Prevention of public nuisance.
- ☐ Protection of children from harm.
- ☒ Public safety

| Year | Percentage |
|------|------------|
| 1950 | 7 |
| 1960 | 8 |
| 1970 | 9 |
| 1980 | 10 |
| 1990 | 11 |
| 2000 | 12 |
| 2010 | 13 |
| 2020 | 14 |
| 2030 | 15 |
| 2040 | 16 |
| 2050 | 18 |

I object to the application being granted at all
I object to the application being granted in it's
current form (If you choose this option remember to
tell us in the next section what changes you would
like to see)

Our objection is based on the following:

You need to complete this box as fully as possible. If you do not then the Committee may not understand why you have objected.

Please attach supporting documents / further pages as necessary - Please number all extra pages

Signed.....

Date.....

Licensing Act 2003 Representation Form



Section 1 - Application Details

I object to the following Application:

Applicant's name (if known): Mr Lakhmir Singh Garewal

Premises name and address: Orchard Corner Convenience Stores, 1-2 The Shopping Centre, St Margarets Road, Leamington Spa, Warwickshire, CV31 2NT

| | |
|---------------------------------|---|
| Application for a | Premises Licence..... <input checked="" type="checkbox"/> |
| | Club Premises Certificate..... <input type="checkbox"/> |
| Application to vary an existing | Premises Licence..... <input type="checkbox"/> |
| | Club Premises Certificate..... <input type="checkbox"/> |
| Application Number | WDCPREM00734 |

Section 2 - Objector details

Individual Objectors Details:

If you are objecting as a representative go to the next section

Applicant Title Mr ☒ Mrs ☐ Miss ☐ Other _____

Surname Nockells

First name(s) DAVID

Address (incl postcode):

73 Shopping Centre
WATFORD

CV31 2NT

Warwickshire Direct
- 3 AUG 2015
Leamington

Please note that a full copy of your objection (including your name and address) is required to be sent to the applicant and will be a public document at any hearing of this matter.

If you do not wish your objection to be made public please complete the box below and give reasons. If you are not prepared to allow your objection to be made public then it may be ruled as unusable or as being less important than a public objection.

☐ Please tick here if you do not wish your objection to be made public and complete the box below

This is because I have a 6 month old baby and dont need people buying drink that early when I live above the shop.

If you represent residents or businesses please complete the boxes below

| | |
|--|--|
| Organisation name if applicable | |
| Please state nature of representation: | |

Section - Objection Details

My objection is relevant to the following licensing objective:

You can tick more than one box

- ☐ Prevention of crime and disorder.
- ☐ Prevention of public nuisance.
- ☒ Protection of children from harm.
- ☐ Public safety

☒ I object to the application being granted at all
☐ I object to the application being granted in it's current form (If you choose this option remember to tell us in the next section what changes you would like to see)

Our objection is based on the following:



You need to complete this box as fully as possible. If you do not then the Committee may not understand why you have objected.

Please attach supporting documents / further pages as necessary - Please number all extra pages

Signed.....

Date.....

| | |
|---|--|
| Licensing Act 2003 Representation Form |  |
| Section 1 - Application Details | |
| I object to the following Application: | |
| Applicant's name (if known): Mr Lakhmer Singh Garewal Premises name and address: Orchard Corner Convenience Stores, 1-2 The Shopping Centre, St Margarets Road, Leamington Spa, Warwickshire, CV31 2NT | |
| Application for a | Premises Licence..... <input checked="" type="checkbox"/> Club Premises Certificate..... <input type="checkbox"/> |
| Application to vary an existing | Premises Licence..... <input type="checkbox"/> Club Premises Certificate..... <input type="checkbox"/> |
| Application Number | |

| | |
|---|---|
| Section 2 - Objector details | |
| Individual Objectors Details: | |
| <i>If you are objecting as a representative go to the next section</i> | |
| Applicant Title | Mr <input checked="" type="checkbox"/> Mrs <input type="checkbox"/> Miss <input type="checkbox"/> Other _____ |
| Surname |  |
| First name(s) |  |
| Address (incl postcode):  | |

Warwickshire Direct
- 3 AUG 2015
Leamington

Please note that a full copy of your objection (including your name and address) is required to be sent to the applicant and will be a public document at any hearing of this matter.

If you do not wish your objection to be made public please complete the box below and give reasons. If you are not prepared to allow your objection to be made public then it may be ruled as unusable or as being less important than a public objection.

☒

Please tick here if you do not wish your objection to be made public and complete the box below

| |
|-----------------|
| This is because |
|-----------------|

If you represent residents or businesses please complete the boxes below

| | |
|--|--|
| Organisation name if applicable | |
| Please state nature of representation: | |

Section - Objection Details

My objection is relevant to the following licensing objective:

You can tick more than one box

- ☒ Prevention of crime and disorder.
- ☒ Prevention of public nuisance.
- ☐ Protection of children from harm.
- ☐ Public safety



I object to the application being granted at all

I object to the application being granted in it's current form (If you choose this option remember to tell us in the next section what changes you would like to see)

Our objection is based on the following:

You need to complete this box as fully as possible. If you do not then the Committee may not understand why you have objected.

Please attach supporting documents / further pages as necessary - Please number all extra pages

Signed

Date 29/7/15

Licensing Act 2003 Representation Form



Section 1 - Application Details

I object to the following Application:

Applicant's name (if known): Mr Lakhmer Singh Garewal

Premises name and address: Orchard Corner Convenience Stores, 1-2
The Shopping Centre, St Margarets Road, Leamington Spa,
Warwickshire, CV31 2NT

| | |
|---------------------------------|---|
| Application for a | Premises Licence..... <input checked="" type="checkbox"/> |
| | Club Premises Certificate..... <input type="checkbox"/> |
| Application to vary an existing | Premises Licence..... <input checked="" type="checkbox"/> |
| | Club Premises Certificate..... <input type="checkbox"/> |
| Application Number | |

Section 2 - Objector details

Individual Objectors Details:

If you are objecting as a representative go to the next section

Applicant Title Mr ☒ Mrs ☐ Miss ☐ Other _____

Surname HANDS

First name(s) GRAHAM

Address (incl postcode):

90, SOUTHWAN 4/5PA

CV31 2PF

Please note that a full copy of your objection (including your name and address) is required to be sent to the applicant and will be a public document at any hearing of this matter.

If you do not wish your objection to be made public please complete the box below and give reasons. If you are not prepared to allow your objection to be made public then it may be ruled as unusable or as being less important than a public objection.

☐ Please tick here if you do not wish your objection to be made public and complete the box below

This is because

If you represent residents or businesses please complete the boxes below

| | |
|--|--|
| Organisation name if applicable | |
| Please state nature of representation: | |

| Section - Objection Details | |
|-----------------------------|-----|
| 1 | 1 |
| 2 | 2 |
| 3 | 3 |
| 4 | 4 |
| 5 | 5 |
| 6 | 6 |
| 7 | 7 |
| 8 | 8 |
| 9 | 9 |
| 10 | 10 |
| 11 | 11 |
| 12 | 12 |
| 13 | 13 |
| 14 | 14 |
| 15 | 15 |
| 16 | 16 |
| 17 | 17 |
| 18 | 18 |
| 19 | 19 |
| 20 | 20 |
| 21 | 21 |
| 22 | 22 |
| 23 | 23 |
| 24 | 24 |
| 25 | 25 |
| 26 | 26 |
| 27 | 27 |
| 28 | 28 |
| 29 | 29 |
| 30 | 30 |
| 31 | 31 |
| 32 | 32 |
| 33 | 33 |
| 34 | 34 |
| 35 | 35 |
| 36 | 36 |
| 37 | 37 |
| 38 | 38 |
| 39 | 39 |
| 40 | 40 |
| 41 | 41 |
| 42 | 42 |
| 43 | 43 |
| 44 | 44 |
| 45 | 45 |
| 46 | 46 |
| 47 | 47 |
| 48 | 48 |
| 49 | 49 |
| 50 | 50 |
| 51 | 51 |
| 52 | 52 |
| 53 | 53 |
| 54 | 54 |
| 55 | 55 |
| 56 | 56 |
| 57 | 57 |
| 58 | 58 |
| 59 | 59 |
| 60 | 60 |
| 61 | 61 |
| 62 | 62 |
| 63 | 63 |
| 64 | 64 |
| 65 | 65 |
| 66 | 66 |
| 67 | 67 |
| 68 | 68 |
| 69 | 69 |
| 70 | 70 |
| 71 | 71 |
| 72 | 72 |
| 73 | 73 |
| 74 | 74 |
| 75 | 75 |
| 76 | 76 |
| 77 | 77 |
| 78 | 78 |
| 79 | 79 |
| 80 | 80 |
| 81 | 81 |
| 82 | 82 |
| 83 | 83 |
| 84 | 84 |
| 85 | 85 |
| 86 | 86 |
| 87 | 87 |
| 88 | 88 |
| 89 | 89 |
| 90 | 90 |
| 91 | 91 |
| 92 | 92 |
| 93 | 93 |
| 94 | 94 |
| 95 | 95 |
| 96 | 96 |
| 97 | 97 |
| 98 | 98 |
| 99 | 99 |
| 100 | 100 |

My objection is relevant to the following licensing objective:

**You can tick more than
one box**

- ☒ Prevention of crime and disorder.
- ☒ Prevention of public nuisance.
- ☐ Protection of children from harm.
- ☒ Public safety

I object to the application being granted at all
I object to the application being granted in it's
current form (If you choose this option remember to
tell us in the next section what changes you would
like to see)

Our objection is based on the following:

You need to complete this box as fully as possible. If you do not then the Committee may not understand why you have objected.

Please attach supporting documents / further pages as necessary - Please number all extra pages

Signed.....

Date.....28-7-15

Licensing Act 2003 Representation Form



Section 1 - Application Details

I object to the following Application:

Applicant's name (if known): Mr Lakhmer Singh Garewal

Premises name and address: Orchard Corner Convenience Stores, 1-2
The Shopping Centre, St Margarets Road, Leamington Spa,
Warwickshire, CV31 2NT

| | |
|---------------------------------|---|
| Application for a | Premises Licence..... <input checked="" type="checkbox"/> |
| | Club Premises Certificate..... <input type="checkbox"/> |
| Application to vary an existing | Premises Licence..... <input checked="" type="checkbox"/> |
| | Club Premises Certificate..... <input type="checkbox"/> |
| Application Number | |

Section 2 - Objector details

Individual Objectors Details:

If you are objecting as a representative go to the next section

Applicant Title Mr ☒ Mrs ☐ Miss ☐ Other _____

Surname HIGHAM

First name(s) DARREN

Address (incl postcode):

HIGHAM'S BUTCHERS
7 SHOPPING CENTRE
ST MARGARETS ROAD
LEAMINGTON SPA
CV31 2NT

Warwickshire Dire
- 3 AUG 2015
Leamington

Please note that a full copy of your objection (including your name and address) is required to be sent to the applicant and will be a public document at any hearing of this matter.

If you do not wish your objection to be made public please complete the box below and give reasons. If you are not prepared to allow your objection to be made public then it may be ruled as unusable or as being less important than a public objection.

☐ Please tick here if you do not wish your objection to be made public and complete the box below

| |
|-----------------|
| This is because |
|-----------------|

If you represent residents or businesses please complete the boxes below

| | |
|--|--|
| Organisation name if applicable | |
| Please state nature of representation: | |

Section - Objection Details

My objection is relevant to the following licensing objective:

You can tick more than one box

- ☒ Prevention of crime and disorder.
- ☐ Prevention of public nuisance.
- ☐ Protection of children from harm.
- ☒ Public safety

☒ I object to the application being granted at all
☐ I object to the application being granted in it's current form (If you choose this option remember to tell us in the next section what changes you would like to see)

Our objection is based on the following:

You need to complete this box as fully as possible. If you do not then the Committee may not understand why you have objected.

Please attach supporting documents / further pages as necessary - Please number all extra pages

Both June, car was burnt completely
in the car park front of shops car park.
Crime is very high in this area with
drink and drugs.
Police will have the report if
needed.

Barrinder Gill saw the car as
well. Councillor who makes.

Signed: 
Date: 27.1.22



These 440 Photos were result of
Yacht on Drugs + alcohol right
front of the Shaps

near orchard Super market.

Burnt with diesel.



PROPOSED LICENSING PLAN

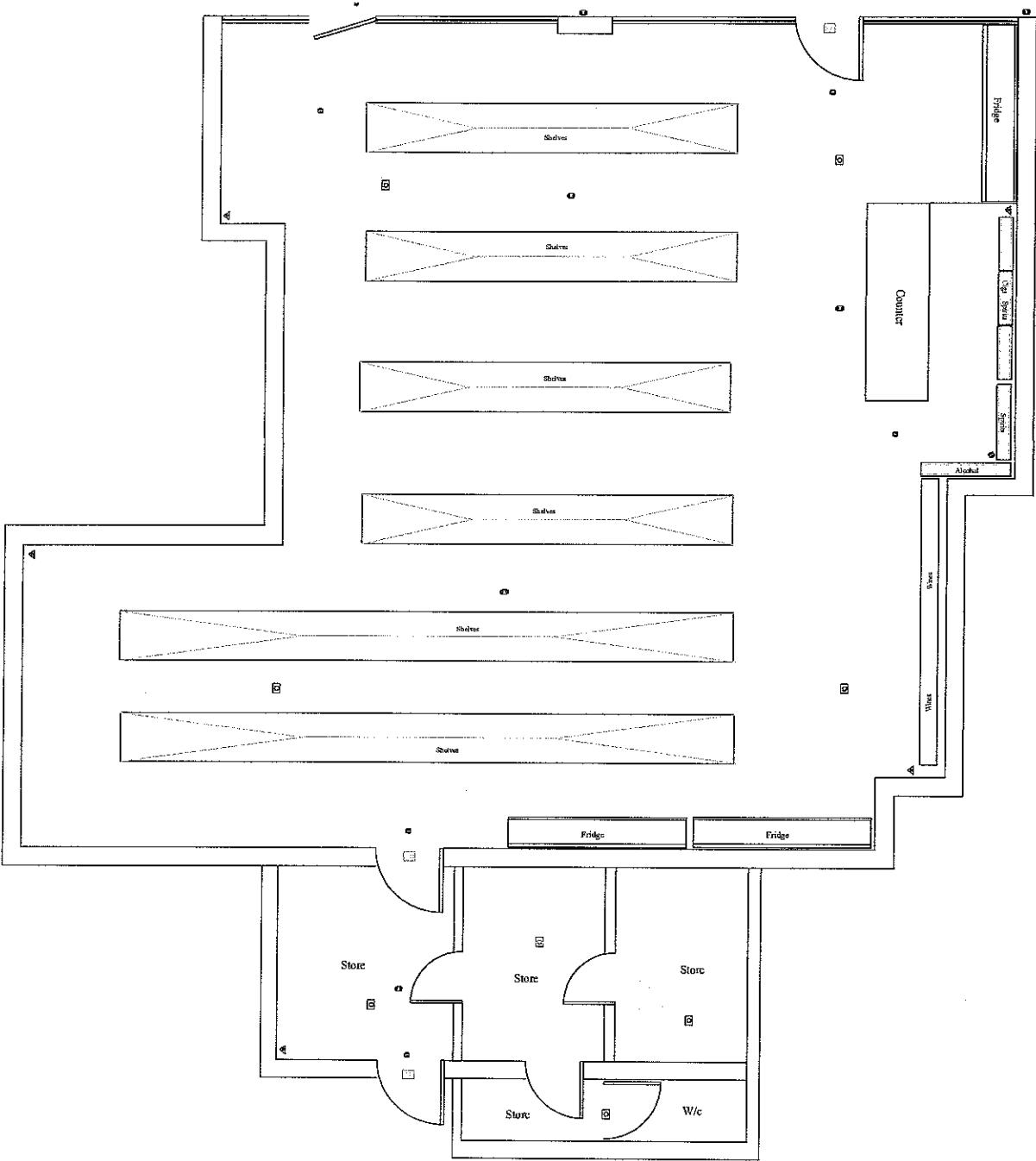

ORCHARD CORNER
1 - 2 ST MARGARET'S ROAD
LEAMINGTON SPA
CV31

KEY

SCALE : 1 : 100

| | |
|--|--------------------|
| | FIRE EXTINGUISHERS |
| | FIRE EXIT SIGNS |
| | EMERGENCY LIGHTING |
| | CCTV CAMERAS |
| CCTV RECORDING 31 DAYS | |
| SHUTTERS PROVIDED | |
| ALARM SYSTEM TO AOI SPEC OR SIMILAR FITTED | |



STATEMENT OF LICENSING POLICY

**Reviewed May 2014 &
Approved by Warwick District Council on 25 June 2014**

Table of Contents

| | |
|--|----|
| Front Cover | 1 |
| Table of Contents | 2 |
| Summary and Purpose | 3 |
| Licensing Policy & South Warwickshire Community Safety Partnership | 4 |
| Delegation of Functions for Regulatory Matters | 4 |
| Further Strategies | 5 |
| The Four Licensing Objectives | 5 |
| Other Considerations | 8 |
| Other Regulatory Regimes | 9 |
| Standard Conditions | 10 |
| Special Policy regarding Cumulative Impact | 10 |
| Responsible Authorities | 11 |
| Early Morning Restriction Orders and Late Night Levy | 12 |
| Restricted Drinking Zone | 12 |
| Further Information | 12 |
| Appendix 2 – Map of Cumulative Impact Zone | 14 |
| Appendix 3 – Responsible Authorities | 15 |

1. Summary and purpose

- 1.1 Warwick District Council (the Licensing Authority) makes this Statement of Licensing Policy in pursuance of its duties and powers under the Licensing Act 2003, (the Act) and the guidance issued under Section 182 of the Act.
- 1.2 Warwick District Council (WDC) is situated in the south of Warwickshire in the centre of England. Appropriately for England's heartland, Warwick District Council's boundaries are roughly heart-shaped, embracing an area of some 28,253 hectares with a population exceeding 138,000 people. The District covers four towns, Royal Leamington Spa, Warwick, Kenilworth and Whitnash as well as a large rural area with 18 Parish Councils. It is acknowledged that the town centres have a large proportion of residential premises.
- 1.3 The policy will relate to current legislation, and, where possible, to local factors, allowing flexibility and the potential to expand and augment the local economy and promote cultural issues.
- 1.4 The aim of this Policy is to demonstrate how WDC, will promote the four licensing objectives. These objectives are:
- prevention of crime and disorder;
 - public safety;
 - prevention of public nuisance; and
 - protection of children from harm.

WDC recognises that the promotion of the Licensing Objectives relies heavily on a partnership between license holders, authorised persons, responsible authorities and other persons in pursuit of common aims.

- 1.5 In making this Policy, the Licensing Authority recognises the following:-
- that residents within, and visitors to the District, need a safe and healthy environment to live, work and visit; and
 - that safe and well run entertainment premises are important to the local economy and vibrancy of the District.
- 1.6 This Statement provides guidance to Responsible Authorities, applicants for and holders of premises licences, objectors and residents on the general approach that the Licensing Authority will implement through its Licensing Committee
- 1.7 When making its decisions on licensing applications, the Licensing Authority will have regard to the matters contained in this Statement, the Act, the guidance issued under section 182 of the Act, the provisions of the Human Rights Act 1998 and in particular, Article 6 (right to a fair and public hearing); Article 8 (right to respect for home, private and family life) and Article 1 of the First Protocol (right to peaceful enjoyment of property and possessions), and the Race Relations Act 1976 and the Race Relations (Amendment) Act 2000.
- 1.8 This Statement covers the period up to 30th August 2018 and will be kept under review and revised as required, following consultation where necessary.

2. Licensing Policy & South Warwickshire Community Safety Partnership

- 2.1 The 1998 Crime and Disorder Act and subsequent amendments require the Police and local authorities to work together and with others to reduce crime and disorder. To this end, Crime & Disorder Reduction Partnerships were formed and are now called Community Safety Partnerships.
- 2.2 South Warwickshire Community Safety Partnership (SWCSP) was formed in September 2008 when the district crime and disorder partnerships for Stratford & Warwick districts merged following years of close collaboration. The vision statement for SWCSP is *'that the districts should be an attractive, environmentally sustainable, desirable area to live in, work and visit, with a sense of safety which reflects the low risk of becoming a victim of crime in the area'*.
- 2.3 Tackling violent crime has remained a priority in Warwick District since 1998 with Leamington Town Centre as the main focus of partnership activity. Tackling violent crime and specifically street violent crime is one of three SWCSP priorities. A 60 point partnership action plan is in place to reduce violent crime and rowdy behaviour in our town centres.
- 2.4 The policy of working with licensees in South Warwickshire has delivered national best performance and practice.
- 2.5 The age group most likely to be victims and perpetrators of violent crime is 18-30. A key initiative to engage with this group is Operation 'Your Town, Your Choice' which takes place on pay-day weekends in hot-spots at the busiest times of 9pm to 4am. An early intervention approach is used utilising direct to leave dispersal authorities together with designated public places powers and has a real impact on reducing violence and rowdy behaviour.
- 2.6 This best example of partnership working across all agencies in South Warwickshire illustrates the commitment to tackling on-street violent crime. In addition enhanced policing, Street Marshals, Street Pastors and CCTV control rooms support this approach.
- 2.7 Joint Licensing Enforcement visits are a key feature of these evenings ensuring that licensees are taking their responsibilities seriously. Engagement with 18 to 30 year olds is carried out on roads closed to traffic. Health related activities are offered in exchange for completing questionnaires on particular themes, for example, pre-loading. Results from these activities and questionnaires inform how and when the hot-spots are staffed and how young people can be assisted in having an enjoyable and safe night. A unique partnership pilot with St John Ambulance Service has provided a care and repair service on busy nights in Leamington called 'The Cabin' and staffed by up to 10 volunteers.
- 2.8 A further developing part of this approach is the Street Pastor Scheme introduced in 2013. The scheme provides a vital service, and integrates well into the overall multi-agency approach adopted. Further information about Street Pastors may be obtained on their website at www.leamingtonspa.streetpastors.org.uk

3 Delegation of Functions for Regulatory Matters

- 3.1 The Council has established a Licensing Committee with delegated powers to deal with licensing matters
- 3.2 The Licensing Committee has delegated the decision making to Licensing Panels when a hearing is required. These Panels are sub-committees consisting of three members of the full Committee. All other matters that do not require hearings have, upon Home Office advice, been delegated to officers.

4 Further Strategies

- 4.1 WDC has adopted the following strategies that it feels will help it to achieve its desired goals:
- It will work together with all partners as well as local businesses and residents to try to achieve an acceptable level of harmonisation between the two, accepting that this may not always be possible.
 - It accepts that an active and successful Crime and Disorder Partnership is one of the key factors in achieving its desired goals.
 - It recognises the importance of working with other agencies and holds and organises a Multi- Agency Licensing Group on a regular basis to discuss any problems that may arise within its district.
 - The value of action plans as a method of obtaining compliance from premises is recognised and used whenever they become necessary.
 - An Enforcement Policy which incorporates the Regulator's Compliance Code has been adopted. Both of these may be found on WDC's website,
 - In recognising the need to minimise late night noise nuisance, WDC would expect that after 23.00 all persons outside the premises would move indoors, and that any sound, amplified or unamplified, from within the premises should not disturb residents in neighbouring domestic properties. However, any conditions added to the premises licence to achieve this aim will be proportionate, enforceable and relevant to that particular premise.
 - WDC has adopted a special policy addressing the cumulative impact of the number of licensed premises in Leamington Spa Town Centre. Full information on this policy may be found at paragraph 10 below.

5. The four Licensing Objectives

5.1 Prevention of Crime and Disorder

- 5.1.1 In addition to the requirement for the Licensing Authority to promote the licensing objectives, it also has a duty under Section 17 of the Crime and Disorder Act 1998 to exercise its functions with due regard to the likely effect of the exercise of those functions, and to do all it reasonably can to prevent crime and disorder in the District.
- 5.1.2 The Licensing Authority will expect all licensed premises to be managed responsibly.

- 5.1.3 When considering applications for premises licences for late night refreshment the Licensing Authority will take into account the potential for high levels of disorder that this type of premises may cause to the night time environment.
- 5.1.4 The Licensing Authority will consider attaching conditions to licences and certificates to prevent crime and disorder. Any such conditions imposed will be tailored to the style and characteristics of the premises and the type of activities expected to take place. Any conditions added will be precise and enforceable and will be unambiguous and clear in what they intend to achieve.
- 5.1.5 The Licensing Authority recognises that there are a number of mechanisms for addressing unlawful or anti-social behaviour that occurs away from licensed premises, qualifying clubs and temporary events. These include:–
- planning controls;
 - enforcement of Environmental Protection legislation (e.g. on noise nuisance);
 - positive measures to provide a safer and clean town centre;
 - environmental controls, in partnership with local businesses, transport operators and other departments of the Council;
 - powers to designate parts of the District as restricted alcohol areas
 - police enforcement of the law with regard to disorder and anti-social behaviour, including the issue of fixed penalty notices;
 - dispersal of people quickly and safely from town centres to avoid concentrations which may produce disorder and disturbance;
 - the prosecution of any personal licence holder or member of staff at such premises who is selling alcohol to people who are drunk;
 - confiscation of alcohol from adults and others in designated areas;
 - all current police and local authority powers of closure in force at the time
 - the power of police, other responsible authorities or a local resident or business to seek a review of the licence or certificate in question.

5.2 Public safety

- 5.2.1 The Licensing Authority will consider attaching conditions to licences and certificates to promote public safety. Any such conditions will be tailored to the style and characteristics of the premises and the type of activities expected to take place there and will be precise and enforceable and will be unambiguous and clear in what they intend to achieve.

5.3 Prevention of public nuisance

- 5.3.1 The Licensing Authority will take an objective view as to the potential for nuisance and will seek to attach appropriate and proportionate conditions to licences and certificates where necessary in order to prevent it. The conditions added will be precise and enforceable and will be unambiguous and clear in what they intend to achieve. Any such conditions imposed will be tailored to the style and characteristics of the premises and the type of activities expected to take place there. In each individual case that arises following representation, the Licensing Authority will:
- consider the potential for nuisance associated with the style, characteristics and activities of the licensable activity involved;
 - examine the potential steps which could be taken to reduce the risk of nuisance, particularly in areas of dense residential accommodation; and

- consider restricting the hours of the licence or the licensable activity only as a last resort because of the potential impact on disorder and anti-social behaviour from fixed and artificially early closing times.

5.3.2 By way of guidance, the Licensing Authority would expect that after 23.00 all patrons of a licensed premises will move indoors, and any amplified sound to be inaudible in neighbouring domestic properties.

5.3.3 Any exceptions to this would need to be justified in an operating schedule showing how the licensing objectives were still being achieved.

5.3.4 The Licensing Authority expects that premises should usually be closed within half an hour of the end of the last licensable activity.

5.3.5 The Live Music Act 2012 removed live music from the scope of the Licensing Authority, subject to the satisfaction of certain criteria, so it is recognised that its controls in this respect have been reduced. However, conditions may be added or reinstated at a review hearing which will bring live music for that particular premises into the licensing regime. This means that it would be within the licensing Authority's powers, at a review hearing, to place a condition on the premises licence prohibiting the playing of live music at any time. This may arise, for example, if the premises is not suitable for the live music being played; or if frequent disturbance is being caused by the music.

5.4 Prevention of Harm to Children

5.4.1 Nothing in this statement of policy limits the access of children to licensed premises unless it is necessary for the prevention of harm to children. However, this authority does not consider that children should be encouraged to mix in areas that are frequented by the adult drinking public, such as busy town centres. For this reason, birthday parties, etc., for the 18 and under demographic will be actively discouraged in these area.

5.4.2 Areas that may give rise to particular concern in respect of children include premises:

- With a known association with drug taking or dealing;
- Where there is a strong element of gambling on the premises;
- Where entertainment of an adult or sexual nature may be provided (e.g. topless bar staff, striptease, lap/table/pole dancing, strong and offensive language).

5.4.3 It is acknowledged that complete exclusion of children will be rare but the options to be considered by the Council for limiting access of children, where regarded as necessary for the prevention of harm to children, may include any of the following:

- Limitations on the hours when children may be present;
- Age limitations (below 18);
- Limitations or exclusions when certain activities are taking place;
- Restrictions or exclusions in respect of parts of premises;

- Requirements for an accompanying adult;
- Full exclusion of people under 18 from the premises when any licensable activities are taking place.

- 5.4.4 The Licensing Authority cannot impose conditions requiring the admission of children to any premises. Where no licensing restriction is necessary, this will remain a matter for the discretion of the individual licensee or club.
- 5.4.5 In the case of premises giving film exhibitions, the Licensing Authority expects licensees or clubs to include in their operating schedules arrangements to ensure that children will be restricted from viewing age-restricted films classified according to the recommendations of the British Board of Film Classifications.
- 5.4.6 Where a number of children are expected to attend regulated entertainment (e.g. theatre production, 'junior disco', film shows), the Licensing Authority may consider the need to require a specified number of adults to be present at the place of entertainment to control the access and egress of children and to assure their safety. The number of adults required will need to be calculated on the basis of a risk assessment by the applicant and will need to take into consideration the size of the venue, the number and ages and ability of the children present and the type of activity involved. These matters will need to be addressed by the applicant as part of the operating schedule.
- 5.4.7 The Licensing Authority will consider attaching conditions to licences and certificates to prevent harm to children. Such conditions will be appropriate to the premises and will be precise and enforceable and will be unambiguous and clear in what they intend to achieve.
- 5.4.8 The Licensing Authority expects all premises to comply with statutory conditions requiring that a policy must be adopted, laying out how they will address underage drinking. This must be shown in the operating schedule of any premises licence application or variation.

NOTE: In the event of any variation submitted to remove any conditions where a hearing is necessary, evidence would be expected to be submitted to the Licensing Panel by the applicant that the change would not impact on the licensing objectives

5.5 Health

- 5.5.1 The Licensing Authority recognises the role of Public Health England acting in its role as a Responsible Authority. Public Health England can make representations in response to either a full licence application or an application for a variation in the conditions of an existing licence. They can also call for the review of a licence if they feel it breaches a licensing objective. Any representation must relate specifically to the premises in question and cannot be a general objection.
- 5.5.1 Representations made by Public Health England must be evidence-based and must demonstrably refer to one or more of the licensing objectives. As there is currently no licensing objective directly relating to public health, Public Health England must ensure their representations are relevant to one of the four existing objectives.

5.6 The Licensing Authority as a Responsible Authority

- 5.6.1 The Licensing Authority are empowered to make representations against new applications for and variations applications to premises licences, as well as call for a review.
- 5.6.2 A procedure has been put into place to ensure that any representation made by the Licensing Authority as a Responsible Authority will be made without prejudicing its ability to determine the application in a fair and objective manner.

6. Other Considerations

6.1 Live Music, Dancing & Theatre

- 6.1.1 This Policy recognises the need to encourage live music, dancing and theatre for the wider cultural benefits of the community generally. In addressing such issues, the potential for disturbance to residents will try to be balanced with the wider cultural benefits to the wider population.

6.2 Integration of Strategies

- 6.2.1 The Licensing Authority will secure the proper integration of this policy with local crime prevention, anti-social behaviour away from licensed premises, planning, transport, tourism and cultural strategies by:
- Liaising and consulting with Warwickshire Police, Community Safety Forum, and considering any guidance from the crime and disorder strategy document; and
 - Liaising and consulting with the appropriate Council Officers, the Planning Committee, the Executive, and considering guidance in the Local Plan.
- 6.2.2 Specific conditions may be attached to premises licences, where appropriate, to reflect local crime prevention strategies. Such conditions may include
- the correct use of well installed closed circuit television cameras;
 - the provision and use of shatterproof drinking receptacles;
 - a drugs and weapons search policy;
 - the use of ID scanners
 - the use of registered door supervisors;
 - specialised lighting requirements;
 - restrictions on hours of opening and licensable activities.
- 6.2.3 Certificates issued to club premises will reflect local crime prevention strategies and may include any or all of the requirements listed above. The Licensing Authority will have regard to any local orders and/or strategies relating to street drinking.

7 Other regulatory regimes

- 7.1 This policy will avoid duplication with other regulatory regimes wherever possible. The following advice relates to specific regimes but is not exhaustive:-

7.2 Health and Safety

- 7.2.1 Premises will normally have been visited by the Council's Health and Community Protection inspection staff with regard to health and safety enforcement at the premises. Certain premises will not fall under this regime and will be the subject of health and safety enforcement by the Health and Safety Executive (HSE). These regimes place a range of general and specific duties on employees, employers, operators of venues and members of the public. Matters arising out of the Health and Safety at Work etc Act 1974 and associated Regulations should not be the subject of conditions that duplicate statutory H&S requirements.

7.3 Fire Safety

- 7.3.1 Premises and their operators will have statutory duties under the current fire safety regime to ensure the safety of patrons visiting the premises. The operating schedule should state the precautions that will be taken to ensure the safety of the public.

7.4 Food Hygiene

- 7.4.1 Premises selling alcohol and/or premises engaged in a food business must be registered with WDC and subject to risk-based food hygiene inspections at regular intervals. The inspections are carried out by the council's Health and Community Protection officers.

7.5 Noise

- 7.5.1 Statutory and public nuisances are dealt with by the Council's Health and Community Safety Section under the Environmental Protection Act 1990 and associated legislation.

7.6 Planning

- 7.6.1 Premises that apply for a licence or a variation of a licence should be aware that they may also need planning permission to carry out the activities applied for.

8 Standard Conditions

- 8.1 The Licensing Authority does not support the use of blanket conditions which, if imposed, may be seen as disproportionate and overly burdensome. Conditions attached to licences will be tailored to the individual styles and characteristics of the premises and events concerned and will be precise and enforceable and will be unambiguous and clear in what they intend to achieve.

9 Enforcement

- 9.1 Inspections of premises will be on a risk assessed basis, to be undertaken when and if judged necessary, assisted by information provided by the Multi Agency Licensing Group.

10 Special Policy Regarding Cumulative Impact

- 10.1 The Licensing Authority recognises that there is a difference between the cumulative impact of premises and commercial need. The latter is a function of market forces and is not a factor the Council may take into account in the discharge of its licensing function.
- 10.2 The Licensing Authority adopted a special policy regarding cumulative impact in November 2005 at the commencement of the Licensing Act 2003 where it considered that a significant concentration of licensed premises would have an impact on the licensing objectives and granting of further licences in that area would add to this impact. When adopting the special policy reference to the steps outlined in the relevant part of the guidance issued under section 182 of the Act.
- 10.3 The Licensing Authority formed two saturation zones, based on information supplied in 2005 on crime and disorder and other related matters. The area and its necessity has been ratified by further figures supplied to the Licensing Authority in January 2009 as part of its review of the cumulative impact policy.
- 10.4 The two zones, when joined together, form the same area as the Leamington Safer Neighbourhood area. In the interest of clarity and transparency, the two zones have been amalgamated into one cumulative impact zone. Properties on both sides of any road which borders the zone are deemed to be included within the zone. A plan of the zone may be found at the end of this policy as Appendix 1.
- 10.5 It is considered that the cumulative impact of further new licences in this zone may lead to the area becoming further saturated with premises of a certain type, including pubs, clubs, takeaways and off licences, making the area a focal point for large groups of people, thereby creating exceptional problems of disorder and nuisance over and above the impact from the individual premises themselves.
- 10.6 The special policy regarding cumulative impact will not be used to try to revoke an existing licence or certificate when representations are made about the way the premises are being operated. However, the special policy may be a justification to refuse an application or to vary a licence or certificate.
- 10.7 The Licensing Authority will not operate a quota of any description including the special policy, that would pre determine an application. Each application will be considered on its individual merits. Proper regard will be given to the contrasting styles and individual characteristics of the premises concerned, and the differing impact they will have on the local community.
- 10.8 If an application for a premises licence within the cumulative impact zone is made, the Licensing Authority will expect the applicant to demonstrate in their operating schedule, the steps to be taken to prevent problems of nuisance and public safety and the steps to be taken to promote the reduction of crime and disorder. **The onus of proof will be on the applicant to show that the application will not impact on the four licensing objectives**

10.9 The Licensing Authority will consider the individual merits of all applications and where it feels to grant the application would be unlikely to add significantly to the cumulative impact in light of the licensing objectives, the Licensing Authority may grant the application.

10.10 The policy will be subject to review.

11 Responsible Authorities

11.1 A list of contact details for Responsible Authorities authorised under the Act is attached to this policy as Appendix 2.

11.2 Responsible Authorities are able to make representations regarding new or variation applications for premises licences and also to seek a review of a current premises licence.

11.3 Representations will only be relevant if they relate to one or more of the licensing objectives referred to in paragraph 5.

12. Early Morning Restriction Orders (EMROs) and Late Night Levy (LNL)

12.1 Following a report from officers, Warwick District Council's Licensing Committee recommended to full Council that it was felt, at the current time, the application of a LNL or EMROs was not appropriate for the council's area.

12.2 The Licensing Committee's recommendation was accepted by full Council during 2013.

12.3 However this Council, in March 2014, has requested officers to review the situation subsequent to Central Government's current consultation on licensing matters and to bring forward an updated report at the earliest possible time on the implications of introducing a late night levy in Warwick District.

13 Restricted Drinking Zone

13.1 The Criminal Justice and Police Act 2001 includes a number of powers to combat crime and disorder, including measures to deal with alcohol related problems. The act gives local authorities the power to designate areas 'Restricted Drinking Zones' where it will become an offence for any person to drink alcohol after being requested not to do so by a police officer.

13.2 The entire area covered by Warwick District has been designated a Restricted Drinking Zone.

13.2 This means that, anywhere in the district, it is an arrestable offence to fail, without reasonable excuse, to comply with a police officer's request to cease drinking alcohol. The police also have the power to confiscate and dispose of any alcohol and containers in the person's possession.

14 Further Information

- 14.1 The Licensing Authority has produced guidance documents for applicants.
- 14.2 The Council's Health and Community Protection Section offers advice on the process for, and, progress of, applications and as to whether particular activities need to be licensed. If detailed advice on the requirements of the legislation and how it affects you and your premises is required, independent legal advice should be sought.
- 14.3 The granting of a licence under the Licensing Act 2003 does not obviate the need for permissions or consents required under other legislation.

Appendix 1 – Cumulative Impact Zone (current for 2013)

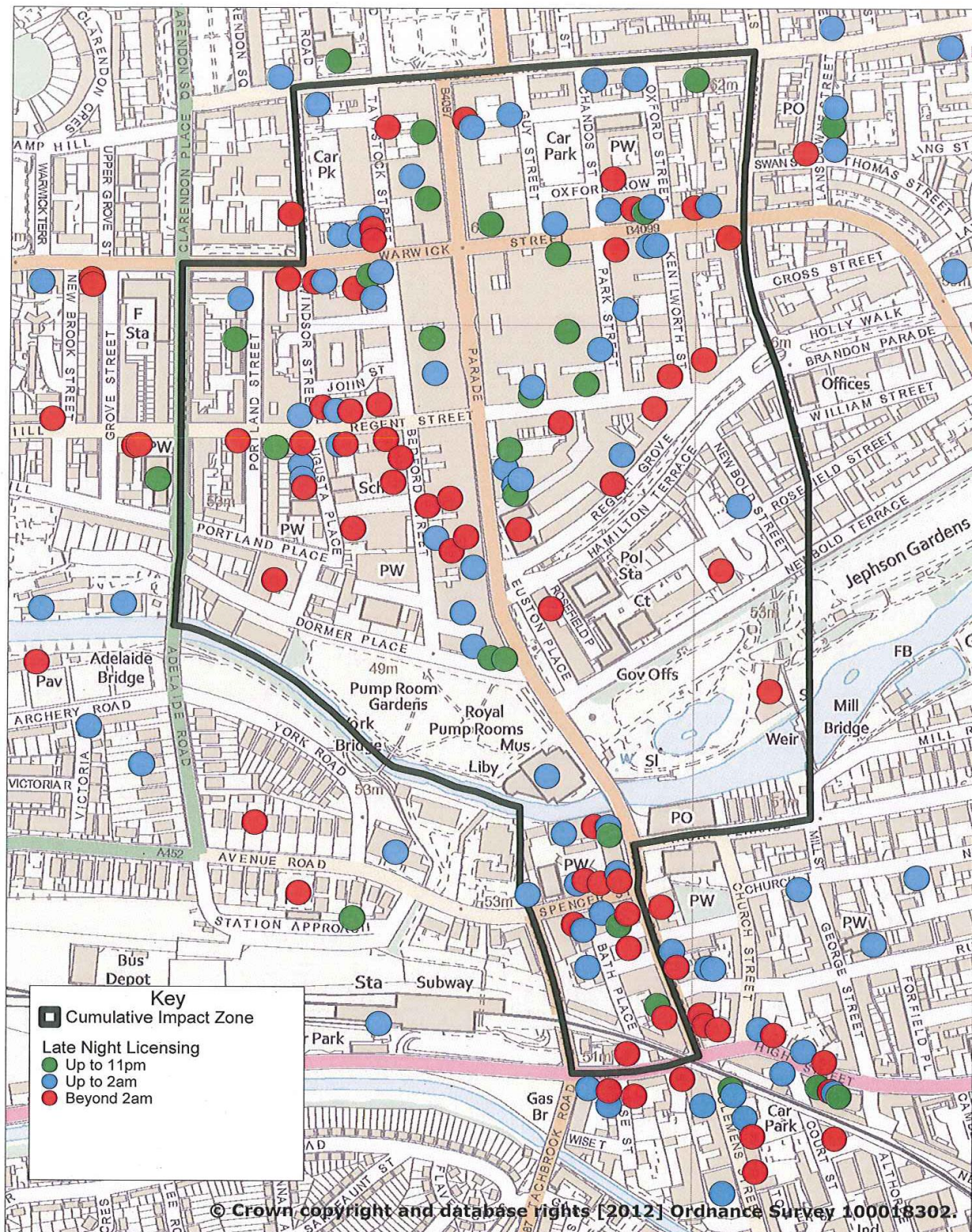

Late Night Licences & Cumulative Impact Zone

Scale: 1:5000

Date: 16 October 2012

Riverside House, Milverton Hill, Royal Leamington Spa, Warwickshire. CV32 5HZ

Tel: 01926 410410



Appendix 2 – List of Responsible Authorities

POLICE:

Chief Officer of Police
Warwickshire Police Licensing Team
Warwickshire Justice Centre Leamington Spa
Newbold Terrace
Leamington Spa
Warwickshire
CV32 4EL

Tel: 01926 684033

Fax: 01926 684038

Email: Liquor.Licensing@warwickshire.pnn.police.uk

FIRE AUTHORITY:

County Fire Officer
Warwickshire Fire & Rescue Service
Warwick Street
Leamington Spa
CV32 5LH

Tel: 01926 423231

E.Mail: firesafety@warwickshire.gov.uk

ENFORCEMENT AGENCY FOR HEALTH AND SAFETY:

Regulatory Manager
Health and Community Protection
Warwick District Council
Riverside House
Milverton Hill
Royal Leamington Spa
CV32 5HZ

Tel: 01926 456707

Email: ehsafety@warwickdc.gov.uk

AUTHORITY RESPONSIBLE FOR ENVIRONMENTAL HEALTH:

Environmental Sustainability Manager
Health and Community Protection
Warwick District Council
Riverside House
Milverton Hill
Royal Leamington Spa
CV32 5HZ

Tel: 01926 456714

Email: ehpollution@warwickdc.gov.uk

THE LICENSING AUTHORITY:

Safer Communities Manager
Health and Community Protection
Warwick District Council
Riverside House
Milverton Hill

Royal Leamington Spa
CV32 5HZ

Tel:
Email:

AUTHORITY RESPONSIBLE FOR PLANNING:

Gary Fisher
Group Leader Development Control
Warwick District Council
Riverside House
Milverton Hill
Royal Leamington Spa
CV32 5HZ

Tel: 01926 456541
Email: gary.fisher@warwickdc.gov.uk

BODY RESPONSIBLE FOR THE PROTECTION OF CHILDREN FROM HARM:

Keith Edwards
Assistant Head of Service
Planning and Performance Children
Young People and Families Directorate
Saltisford Office Park,
Ansell Way
Warwick
CV34 4UL

Tel: 01926 731139
Email: sslicensingapplications@warwickshire.gov.uk

WARWICKSHIRE COUNTY COUNCIL (WEIGHTS & MEASURES):

Simon Coupe
Divisional Trading Standards Officer
Old Budbrooke Road
Warwick
CV35 7DP

Tel: 01926 414040
Email: simoncoupe@warwickshire.gov.uk

PUBLIC HEALTH ENGLAND:

Public Health Department (Licensing)
NHSWarwickshire/Warwickshire County Council
PO Box 43 – Shire Hall
Warwick
CV34 4SX

Email:
PublicHealth5PMPUBLICHEALTHWARWICKSHIREPCT@warwickshire.nhs.uk